



School Committee
Meeting

October 23, 2013
7:00 pm

Town Hall
Selectmen's Meeting Room



SHREWSBURY PUBLIC SCHOOLS
SCHOOL COMMITTEE MEETING
AGENDA
October 23, 2013 7:00pm
Town Hall—Selectmen's Meeting Room
Amended from original posting on 10/18/13



<u>Items</u>	<u>Suggested time allotments</u>
I. Public Participation	7:00 – 7:10
II. Chairperson's Report & Members' Reports	
III. Superintendent's Report	
IV. Time Scheduled Appointments	
A. Superintendent's Awards: Student Recognition	7:10 – 7:25
B. Proposed SHS Service Learning Trip: Vote	7:25 – 7:35
B. Shrewsbury Public Library: Presentation	7:35 – 8:00
C. Enrollment & Class Size: Report	8:00 – 8:30
D. Fiscal Year 2014 Staffing: Report	8:30 – 8:45
V. Curriculum	
VI. Policy	
A. Bullying Prevention and Intervention Update: Second Reading & Vote	8:45 – 8:50
VII. Budget	
VIII. Old Business	
IX. New Business	
A. Proposed Dedication of Parker Road Preschool Playground: Vote	8:50 – 9:00
X. Approval of Minutes	
XI. Executive Session	9:00 – 9:30
XII. Information Enclosures	
XIII. Adjournment	9:30

Next meeting: November 6, 2013



**SHREWSBURY PUBLIC SCHOOLS
SCHOOL COMMITTEE**

ITEM NO: I. Public Participation

MEETING DATE: 10/23/13

SPECIFIC STATEMENT OR QUESTION:

Will the School Committee hear thoughts and ideas from the public regarding the operations and the programs of the school system?

BACKGROUND INFORMATION:

Copies of the policy and procedure for Public Participation are available to the public at each School Committee meeting.

ITEM NO: II. Chairperson's Report/Members' Reports

SPECIFIC STATEMENT OR QUESTION:

Will the School Committee hear a report from Ms. Sandra Fryc, Chairperson of the School Committee, and other members of the School Committee who may wish to comment on school affairs?

BACKGROUND INFORMATION:

This agenda item provides an opportunity for the Chairperson and members of the Shrewsbury School Committee to comment on school affairs that are of interest to the community.

STAFF AVAILABLE FOR PRESENTATION:

Ms. Sandra Fryc, Chairperson
Mr. John Samia, Vice Chairperson
Mr. Jason Palitsch, Secretary
Ms. Erin Canzano, Committee Member
Dr. B. Dale Magee, Committee Member

ITEM NO: III. Superintendent's Report

SPECIFIC STATEMENT OR QUESTION:

Will the School Committee hear a report from Dr. Joseph M. Sawyer, Superintendent of Schools?

BACKGROUND INFORMATION:

This agenda item allows the Superintendent of the Shrewsbury Public Schools to comment informally on the programs and activities of the school system.

STAFF AVAILABLE FOR PRESENTATION:

Dr. Joseph M. Sawyer, Superintendent of Schools

ACTION RECOMMENDED FOR ITEMS I, II, & III:

That the School Committee accept the report and take such action as it deems in the best interest of the school system.



SHREWSBURY PUBLIC SCHOOLS
SCHOOL COMMITTEE

ITEM NO: IV. Time Scheduled Appointment

MEETING DATE: 10/23/13

A. Superintendent's Awards: Student Recognition

SPECIFIC STATEMENT OR QUESTION:

Will the School Committee hear a presentation from Dr. Joseph M. Sawyer regarding the Superintendent's Awards for 2013-2014?

BACKGROUND INFORMATION:

1. The Massachusetts Association of School Superintendents requests that each superintendent, on its behalf, recognize outstanding members of the senior class in each district's high school. Due to the size of the district, Dr. Sawyer is allowed to present the award to two students.
2. Dr. Sawyer has selected Olga Yushkova and Catherine Zhang.
3. Dr. Sawyer will provide highlights of each student's achievements, recognize each student, and ask each to make a brief statement. Information on each student is attached.

ACTION RECOMMENDED:

That the School Committee hear the presentation and take whatever steps it deems necessary in the interests of the Shrewsbury Public Schools.

STAFF AVAILABLE FOR PRESENTATION:

Dr. Joseph M. Sawyer, Superintendent of Schools

SUPERINTENDENT'S AWARDS 2013-2014

DISTRICT	SCHOLAR'S NAME	SCHOLAR'S PROFILE
<p>School District: Shrewsbury</p> <p>School: Shrewsbury High School</p> <p>Principal: Todd Bazydlo</p>	<p>Olga Yushkova</p>	<p>Academic:</p> <ul style="list-style-type: none"> • Secretary of National French Honor Society • National Honor Society member • Top 10% for 2 years in French National Contest <p>Non-Academic:</p> <ul style="list-style-type: none"> • Modern Dance for 5 years • Volunteer at Saint Vincent Hospital • Volunteer at Shrewsbury Public Library for 5 years <p>Personal:</p> <ul style="list-style-type: none"> • –Moved from the Ukraine at the age of 5 and had to get used to new faces, smells, behaviors, while dealing with the difficulty of being away from relatives. Learning the English language was a struggle as well as figuring out things to talk to other kids about. The family visits the Ukraine every summer, but it is still hard to be away from family. Has had the opportunity to travel and meet people from around the world.

SUPERINTENDENT'S AWARDS 2013-2014

DISTRICT	SCHOLAR'S NAME	SCHOLAR'S PROFILE
<p>School District: Shrewsbury</p> <p>School: Shrewsbury High School</p> <p>Principal: Todd Bazydlo</p>	<p>Catherine Zhang</p>	<p>Academic:</p> <ul style="list-style-type: none"> • Harvard Book Award • National Merit Semi-Finalist • Research fellow for the American Junior Academy of Sciences <p>Non-Academic:</p> <ul style="list-style-type: none"> • Silver Medal at International GENIUS (Global Environmental Conference) Olympiad • National Qualifier in Student Congress (Speech and Debate) • Alice Francis Wolfe Award for Dedication and Excellence <p>Personal:</p> <ul style="list-style-type: none"> • Traveling to Scotland and staying there for a month opened eyes to new cultures. She tried haggis, saw flocks of sheep and met people from around the world.



**SHREWSBURY PUBLIC SCHOOLS
SCHOOL COMMITTEE**

ITEM NO: IV. Time Scheduled Appointment **MEETING DATE: 10/23/13**
B. Proposed SHS Service Learning Trip: Vote

SPECIFIC STATEMENT OR QUESTION:

Will the School Committee approve travel by Shrewsbury High School students to the Dominican Republic to participate in a community service project from April 18-25, 2014?

BACKGROUND INFORMATION:

1. As part of the high school's efforts to promote community service, student leadership and global education, Mr. Bazydlo is requesting approval of a service learning and leadership trip to the Dominican Republic in April 2014 (over April school vacation). His memo follows.
2. Mrs. Busso traveled to the Dominican Republic this past summer as part of an educator trip to investigate the possibilities for Shrewsbury High School. A memo from Mrs. Busso explaining the trip and its benefits is enclosed.

ACTION RECOMMENDED:

That the School Committee vote to approve travel by Shrewsbury High School students to the Dominican Republic to participate in a community service project from April 18-25, 2014.

STAFF AVAILABLE FOR PRESENTATION:

Mr. Todd Bazydlo, Principal Shrewsbury High School
Mrs. Patricia Busso, Mathematics Teacher, Shrewsbury High School

Shrewsbury High School
64 Holden Street
Shrewsbury, Massachusetts 01545
Office of the Principal



Memorandum

To: Dr. Joseph Sawyer
From: Todd Bazydlo
Date: October 17, 2013
Re: Community Service Project in the Dominican Republic

Attached please find a request from Mrs. Patricia Busso for approval of an international overnight trip to the Dominican Republic for students to participate in a community service project in April of 2014. As you can see from the attached proposal, we would contract with Education First (EF) who specializes in student travel and has developed a program that focuses on service, global citizenship and leadership. During the trip students will participate in numerous activities to deepen their understanding and appreciation of service related projects and reflect upon the impact their work will have on the citizens of the Dominican Republic. Mrs. Busso has provided all of the information required by School Committee Policy #537. The group would depart Shrewsbury on the April 18 and return on the April 25. The projected cost of the field trip is \$2,700 including all meals, taxes, etc. Shrewsbury High School will attempt to defray the cost of this trip by looking for a corporate sponsor(s) and students will have the opportunity to utilize EF's web based individual fundraising page prior to the trip.

Mrs. Busso and I look forward to having the opportunity to present this proposal to the school committee in the near future. Please contact me if you have any questions.

Shrewsbury High School Mission Statement

The Shrewsbury High School community provides challenging, diverse learning opportunities; promotes creativity and independent thinking; and empowers students to become capable, caring, active contributors to the world in which they live.

SHREWSBURY HIGH SCHOOL

SERVICE LEARNING PROJECT

From: Patricia Busso, Math Teacher
Shrewsbury High School
To: Todd Bazydlo, Principal
Shrewsbury High School
Date: October 17, 2013
RE: Proposal for Service Learning Project to the Dominican Republic, April 2014

As a service learning project, Shrewsbury High School would like to take a group of students to the Dominican Republic over April vacation to work with a community service organization helping people in underserved communities. The agency with which we would be working is called the Community Service Alliance (CSA) and their mission it is to respond directly to local needs, as well as facilitate life-changing experiences for those receiving the services by making them active participants in their projects. Students would be working alongside these members of the community helping to provide the infrastructure and tools needed to host educational programs, provide health care, and create community centers. More specifically, students would most likely be helping to build a clinic, school, community center, or working on other improvements to homes/facilities.

In addition to the hands-on work students will be doing, they will also participate in daily reflection and global citizenship activities.

The travel company we would be using is Education First (EF.) I was fortunate enough to visit the Dominican Republic with EF this summer. I met members from six different community service projects throughout the country and felt this particular site was the one for which the students would most easily see tangible results from their efforts. I was also able to see the lodge at which we would be staying and enjoyed lunch there. I was extremely impressed with the groundwork EF had done and the authentic, sustainable projects they had researched and shown us.

An informational meeting to gauge student interest for the proposed trip was held on October 10th, 2013 and was attended by almost sixty students. As we are currently offering the trip only to upperclassmen, the freshmen and sophomores who attended were put on a waitlist. Interested students were given the trip itinerary and asked to fill out and return a form stating why they wanted to go on the trip and asking parents to sign indicating their support if the trip moves forward. To date, I have received 25 forms back from students who want to commit to the trip. Many stated they had always wanted to do something like

this, some had already done mission work with their churches domestically, and others said they've been told this is a life-changing opportunity...and I agree!
A meeting for seriously interested students and their parents will be held in the high school media center on Thursday, October 24th at 6pm. Jon Blachly from EF will be there to answer all questions.

Based on the response forms, I would anticipate a group of between 15-25 students, with 3-5 chaperones. Dawn Vigliatura, the service learning coordinator, has expressed her desire to participate, as have several other teachers so there would be no problem securing chaperones.

The proposed dates are Friday 4/18/13 – Friday 4/25/13. Point of departure and return would be Boston. In the Dominican Republic we would be staying at the Tubagua Plantation Eco Village in the forest outside the city of Puerto Plata.

The trip would cost \$2720 per student. EF provides students with their own individual fundraising webpages, to which family and friends can donate. I would also anticipate a group fundraiser to help defray the cost. Additionally, for every 8 students we enroll before November 15th, we will earn a \$400 scholarship.

For more detailed information, please see:

“Proposal Specifications”

“From the Ground Up: Transforming Mountain Villages” for a detailed explanation of the project and accompanying daily itinerary.

“EF Service Learning” for details on the educational component of the trip, as there will be daily reflection and global citizenship activities.

“EF Guidelines and regulations” for their trip rules.

“Everything You Get” from EF

Proposal Specifications

Number of Students:	15-25 (in triples)
Number of Chaperones:	3 – 6 (in doubles or triples)
Accommodations:	Seven nights stay at the Tubagua Plantation Eco Village, Tubagua, Dominican Republic (about one half-hour outside the city of Puerta Plata)
Air Transportation:	Round-trip coach airfare from Boston to New York, and New York to Puerta Plata is included in the price.
Meals:	All meals are included in the price. These meals will include 7 breakfasts, 6 lunches, and 7 dinners.
Sightseeing:	Entrance fee to Gri Gri Lagoon Mangrove boat tour and sightseeing guide are included in the price.
EF Support:	Access for full-service website and customer service, as well as a full-time tour director and service director on-site are included in the price.
Service Learning:	Daily reflection and global citizenship activities are included.
Payment Schedule:	Education First requires a \$95 to enroll in the trip. The company will then set up individual payment plans with families via our trip's website.
Cancellations:	Cancellation policies will be distributed to parents at the informational meeting on 10/24/13 and are accessible through the EF website.
Insurance:	Optional insurance coverage will be made available to participants

From the Ground Up: Transforming Mountain Villages

2013 Price: \$2720

Trip Code: DRA

Program Themes: Community Development, Youth Development, Poverty Alleviation, Public Health, Language Training, and Leadership

Types of Service: Construction (Sanitation, Schools, Homes), Leadership Activities, Painting, Gardening, Language Instruction, and Public Health Workshops

Trip Length	Service Hours	# TDs	Capacity	Departures Dates
8 Days	35	1	10-35	OPEN

Accommodations	Immersion	Adventure	Service	Travel	Physicality
4	5	2	5	2	4

(1 = Easy/Very Comfortable, 5 = Intense/Less Comfortable)

Introduction:

As the disparity between wealth and poverty in the world grows greater every year, there is no question that the work of your generation has the power to play a crucial role in closing that gap. Life for most of the world's seven billion people is a constant struggle, with many unable to access clean water, ample food, and protection from the elements on a daily basis.

The problems of the world are great, and it would be impossible to erase them overnight. However, we at EF have reason to believe that you can make a difference. For decades now, our non-profit partners have been running development projects in some of the world's more remote and underprivileged areas. Year after year they work with communities and learned that there is still hope. Despite the hardships that people face around the world, change for the better is happening, and it is easier to accomplish than most people realize.

According to the World Bank (2009), approximately 50.5% of the population in the Dominican Republic lives at the poverty line. Among the hardest regions hit are the mountain villages of Lajas, El Sonador, El Mango and Yaroa Abajo outside of Puerto Plata. These areas present important deficiencies such as challenges with transportation (due to the fact that there is a bridge that was washed out and communities get trapped after heavy rains), poor infrastructure for clinics and schools and need for education and support to the community's children and youth.

To address these challenges, our non-profit partner has been working with a Catholic organization for numerous years in these communities. Along with spiritual support through local churches, Padre Pepe, Carmello and Rafael have been instrumental in encouraging community participation to plan and execute initiatives such as reparation of homes, operation of summer camps, community center and school construction and other activities.

Program Snapshot:

For this program EF has partnered with the nonprofit organization Community Service Alliance (CSA). CSA has been in operation since 2004, and their mission is to channel human and financial resources to communities and organizations in the Dominican Republic, not only helping to respond directly to local needs, but also to facilitate life changing experiences for participants. This mission supports their overall vision: to contribute to the overall development of communities in the Dominican Republic, while also facilitating the personal transformation of their participants. All of their activities and programs are designed around these ideas. What that means is you will never take part in a 'make-work' service activity. Rather, your participation in the local community is part of a larger initiative that is designed to bring about meaningful and sustainable positive change.

The goal of this program is to improve the quality of life for the people in underserved communities through building and renovating homes, community centers, schools, latrines, water and sewage facilities, sidewalks, and community gardens, and to deliver basic health education and English language programs in a fun and dynamic setting. In many cases, you will find yourself working alongside members of the community to accomplish these tasks. You will also be involved in ecological education in conjunction with the local community leaders. In the process, you become an important and welcomed part of these communities who need assistance as they strive for a better life for their families.

A typical day might involve an early arrival to the construction site, followed by a safety briefing and an outline of the day's goals. After a quick stretch, your team will split into smaller groups and get started on the morning tasks – often times the most strenuous tasks are accomplished in the morning. Lunch break is generally 1.5 hours in a cool, shaded area, giving you plenty of time to rehydrate and digest before heading back out into the afternoon sun. You will take part in a variety of tasks, working hand-in-hand with local construction foremen and community workers to make sure your team achieves the day's goals. You will be surprised not only by how much your group accomplishes in a day (and amazed by what you accomplish in a week), but also by how much you learn about the resourceful and ingenious construction methods that Dominicans execute with inspiring ease.

'From the Ground Up' is an intensive service program with a global citizenship academic component. Whether you're aspiring to start your own grassroots service project, to learn about contemporary issues in the Caribbean, or to challenge yourself to be a part of positive community change, EF cordially invites you to join us in the Dominican Republic for this exciting new program.

Description of Service:

The wants and needs of the community change daily, so advanced project planning is almost impossible to do. That said, the overall objective of CSA's interventions is to provide communities with the infrastructure and tools needed to host educational programs, workshops and community events, as well as ensure that they have safe, healthy and decent homes to return to at the end of the day. Groups will most likely spend time on projects such as building and/or renovating schools, community centers, houses, water and sewage systems, sidewalks and other improvements to community homes and facilities. Construction tasks may include but are not limited to painting, mixing cement, laying and plastering cinder brick, digging latrines and cisterns, building wood frames and structures and many other hands-on activities. These tasks involve moderately strenuous volunteer work; however no experience in construction, carpentry or building is necessary.

To date, CSA's support to these communities have resulted in medical outreaches, summer camps for children, a school annex building in El Mango and latrines in Sonador and Yaroa Abajo. They have also constructed the foundations of a Community Youth Center at El Mango. This Center is about 30x20 meters and will eventually be teaching center for basic English/Spanish, math, geography, ecology, arts, crafts and recreational games.

Students will also have the opportunity to repair, restore and construct local homes and schools. Families and communities are selected by the "Padres" to receive support in the reparation and/or construction of homes/schools. These communities consist of families that are unable to repair their homes on their own and live in situations of extreme poverty. There is also a lack of funds for the local schools and many children have to walk far to attend classes; therefore, building a school in the community, creates quicker and easier access to school. Groups will work together with the beneficiary families to repair and/or construct their homes. Again, no construction experience is necessary.

Accommodations:

Students stay at Tubagua Plantation Eco Village near the city of Puerto Plata - roughly a half-hour from Puerto Plata. Here you sleep in Robinson-Crusoe style, thatch-roof *palapas* hand-hewn from local, renewable materials that feature comfortable beds and offer amazing views of Montellano, Puerto Plata and Caraballo from Tubagua's mountaintop perch nearly 1,000ft above sea-level. There are plenty of shower areas, flushing toilets and separate sleeping cabins for males and females.

Aside from the view, meals are arguably the best part of the accommodations! Breakfast is served around 7am and consists of cereal, juice, coffee, tea, yogurt and fruit and then a hot selection of eggs, bacon, ham, potatoes and other Dominican

breakfast staples including bananas and local fruits. Lunch is eaten at the project site and each volunteer prepares their own packed lunch at Tubagua to bring with them. Dinner consists of a variety of Dominican and international meals including tropical salads, rice, beans, potatoes, chicken, fish, pasta and other hearty foods washed down with juices, water and tea. There will be a vegetarian option for all meals but please remember to let EF know if you have any food allergies or particular dietary requests or restrictions. Everyone will participate in the cleanup and dishwashing and maintain the spirit of service in to helping keep the common areas clean and tidy.

General Program Itinerary:

Day 1: **Arrival**
Location: **Puerto Plata or Santiago**
Accommodation: **Tubagua Eco Lodge**

3:00 pm	Arrival into STI/POP International Airport Transfer via air-conditioned bus to hotel
5:30 pm	Check in, unpack, & settle-in to the hotel
6:00 pm	Welcome Dinner
10:00 pm	Lights Out

Day 2: **Orientation and Dancing**
Location: **El Mango**
Accommodation: **Tubagua Eco Lodge**

7:30 am	Breakfast
9:00 am	Orientation and Community Tour
12:00 pm	Lunch
1:00 pm	Global Citizenship Activity I
1:30 pm	Service Projects
4:00pm	Return to hotel
6:00 pm	Dinner
7:00 pm	Reflection Activities
8:00 pm	Merengue and Bachata Dance Lessons
10:00 pm	Lights Out

Day 3: **Service Projects Continue**
Location: **El Mango**
Accommodation: **Tubagua Eco Lodge**

7:30 am	Breakfast
9:00 am	Service Projects

12:00 pm	Lunch
1:00 pm	Global Citizenship Activity II
1:30 pm	Service Projects
4:00pm	Return to hotel
6:00 pm	Dinner
7:00 pm	Reflection Activities
8:00 pm	Movie Night
10:00 pm	Lights Out

Day 4: **Service Projects Continue**
Location: **El Mango**
Accommodation: **Tubagua Eco Lodge**

7:30 am	Breakfast
9:00 am	Service Projects
12:00 pm	Lunch
1:00 pm	Global Citizenship Activity III
1:30 pm	Service Projects
4:00pm	Return to hotel
6:00 pm	Dinner
7:00 pm	Reflection Activities
8:00 pm	Community Forum/Workshop
10:00 pm	Lights Out

Day 5: **Service Projects and Waterfall Hike**
Location: **El Mango**
Accommodation: **Tubagua Eco Lodge**

7:30 am	Breakfast
9:00 am	Service Projects
12:00 pm	Lunch
1:00 pm	Global Citizenship Activity IV
1:30 pm	Return to hotel for Waterfall Hike
6:00 pm	Dinner
7:00 pm	Reflection Activities
8:00 pm	Community Forum/Workshop
10:00 pm	Lights Out

Day 6: **Service Projects Continue**
Location: **El Mango**
Accommodation: **Tubagua Eco Lodge**

7:30 am	Breakfast
9:00 am	Service Projects
12:00 pm	Lunch
1:00 pm	Global Citizenship Activity V

1:30 pm Sports Games with Local Community
4:00 pm Return to hotel
6:00 pm Dinner
7:00 pm Reflection Activities
10:00 pm Lights Out

Day 7: Beach Day
Location: Sosua Beach
Accommodation: Tubagua Eco Lodge

6:30 am Breakfast
9:00 am Departure for Sosua Beach
12:00 pm Picnic on the beach
1:00 pm Swimming and Snorkeling
4:30 pm Return to hotel
7:00 pm Farewell Dinner
8:00 pm Program Wrap-Up/Reflection
10:00 pm Lights Out

Day 8: Return Home
Location: Puerto Plata or Santiago
Accommodation: N/A

7:30 am Breakfast
9:00 am Say goodbyes/Pack
11:00 am Departure for Airport

Suggested Reading:

501 Spanish Verbs, Kendris

Sana, Sana Culito de Rana, Alan Cambeira

El Tigre Dominicano, Lipe Collado

The Devil Behind the Mirror, Globalization and Politics in the DR, Steven Gregory

Suggested Videos:

Trujillo: El Poder del Jefe I, Rene Fortunato (1991)

Sugar, by Anna Boden (2009)

EF SERVICE LEARNING

AUTHENTIC SERVICE PROJECTS + COMMUNITY IMMERSION + MINDFUL APPROACH

Every Service Learning Tour is unique, but they all share a common goal: To instill in our participants humanitarian values and virtues vital to a life dedicated to service. Our programs are designed to inspire young people to lead and serve others with cultural empathy, critical thinking, and compassionate leadership. Students will learn firsthand about pressing societal challenges, particularly generational poverty, gender equality, access to education, public health, and preservation of the environment and its natural resources.

Students will enhance their problem-solving skills as they collaborate with locals to effect positive and sustainable change in the community. They will return home with a deeper appreciation for working together with others and renewed motivation to affect global change.

YOUR SERVICE TOUR INCLUDES:

Access to the weShare program, which is a pre-trip project-based online learning platform that provides background country and project information to extend and deepen student engagement with their service learning experience.

Structured reflection exercises that challenge students to step outside their comfort zones and that promote the development of “intangible” skills, such as empathy, mindfulness, compassion, self-confidence, and cultural awareness.

- **Service Reflection** is a daily evening program that helps students to think critically and deeply about their service project and the importance of it to the local community and country at large. The Tour Facilitator will lead activities and discussion to help students to process their daily experiences. A key component of this reflection is student engagement with a personal journal. The Tour Facilitator should constantly encourage students to be making notes and observations in their journals throughout the day and during these reflective periods. The Tour Facilitator will also ask them to challenge each other’s notions about the value of service and the new country and culture in which they are living. Students will be asked to grapple with the global issues their service projects highlight and decide together on how they will continue to work to address them from their home communities.

Mindful approach to global citizenship, which includes group activities and discussions where students gain a solid understanding of global issues, including why they exist, the challenges they address, and the importance of global collaboration.

- **Global Connections** is a daily morning program that engages students with the notion of global citizenship. EF Service Learning defines global citizenship as collaboration across language, geography, and culture to

address challenges that we, as the human race, face. Through activities and discussion, students will gain a stronger understanding of a range of global issues that pertain to their particular service project, and they will learn to draw connections between their home communities and experiences and those of the new people they meet while abroad. Global Connections will help students see the importance of international cooperation and collaboration. Most importantly, this program will strengthen students' commitment to service and compel them to continue to expand their global awareness and that of those around them.

Meaningful, authentic and sustainable service learning projects centered around a real need in a local community, allowing students to make a relevant and positive impact while acquiring tangible and intangible life skills in an international setting.

EVERYTHING YOU GET:

We have a Powerful Network of Partnerships and NGO alliances that allows us to plan long-term sustainable projects that are based on the community's actual wants and needs. This ensures that all of our programs are of the highest quality and include authentic community exchange and immersion activities.

Community Immersion. We know that true service starts with relationships. Our programs limit touring to enable students to develop close connections with a local community and its people, learning about the way they live and work firsthand.

Full-time Tour Facilitator who frames and contextualizes the service project, while coordinating with our local community partners. The Tour Facilitator also engages students in daily reflections to reinforce the trip learning goals and personalize the experience.

President's Volunteer Service Award. Students will have the opportunity to complete 10-40 service hours, depending on their project. Our service learning programs are proudly recognized with the President's Volunteer Service Award for meeting standards in service excellence.

All of the details are covered: Round-trip flights on major carriers; Project planning and oversight; Comfortable ground transportation; Overnight stays in hotels or dormitory-style accommodation; breakfast, lunch and dinner.



**SHREWSBURY PUBLIC SCHOOLS
SCHOOL COMMITTEE**

ITEM NO: IV. Time Scheduled Appointment
C. Shrewsbury Public Library: Presentation

MEETING DATE: 10/23/13

Will the School Committee hear a presentation from the Shrewsbury Public Library Board of Trustees regarding the proposed renovation and expansion of the library?

BACKGROUND INFORMATION:

1. The October 2013 Special Town Meeting authorized the Library Trustees to apply for State Library Construction Grant funds. The state Board of Library Commissioners has communicated that state funding of approximately \$7.96 million is available. A Special Town Meeting has been scheduled for October 21, 2013 and a debt exclusion election will be held on November 5, 2013 in order to determine whether the Town will provide its share of funding for the project, which is estimated to be approximately \$13.6 million.
2. A member of the Library Board of Trustees and the Library Director will present information about the project to the School Committee and request its support of the project.

ACTION RECOMMENDED:

That the School Committee review the presentation and take whatever action it deems necessary in the best interest of the Shrewsbury Public Schools.

INDIVIDUALS AVAILABLE FOR PRESENTATION:

Ms. Joan Barry, Library Board of Trustees
Ms. Ellen Dolan, Director, Shrewsbury Public Library



**Update from the Library
Building Committee
to the Shrewsbury School Committee
October 23, 2013**

Town of Shrewsbury, Massachusetts

100 Maple Avenue | Shrewsbury, MA 01545 | www.shrewsbury-ma.gov



- The Library Building Committee (LBC) seeks a \$23.3 Million appropriation under Article 17 of the October 21, 2013, Special Town Meeting.
- The budget of \$23.3 Million anticipates that the project delivery method will be via G. L. c. 149A – CM at Risk.
- The local share of the project will not exceed \$13.6 Million and is conditioned on a debt exclusion question being approved.

Town of Shrewsbury, Massachusetts

100 Maple Avenue | Shrewsbury, MA 01545 | www.Shrewsbury-MA.gov







Article 17

Grant Funding	\$ 7,959,989	34.16%
Donations	\$ 1,750,000	7.51%
Tax Levy	\$13,600,000	58.33%
Total	\$23,300,000	

Town of Shrewsbury, Massachusetts
 100 Maple Avenue | Shrewsbury, MA 01545 | www.Shrewsbury-MA.gov





Impact on Average Single Family Taxpayer

Fiscal Year	Exempted Debt Service Current Authorized	Additional Library Project	Total	Difference In Amount Paid to FY 2014
FY 2014	\$385.82	\$0.00	\$385.82	\$0.00
FY 2015	\$369.89	\$1.16	\$371.05	(\$14.77)
FY 2016	\$348.62	\$18.06	\$366.68	(\$19.14)
FY 2017	\$297.33	\$27.09	\$324.42	(\$61.40)
FY 2018	\$323.41	\$105.41	\$428.82	\$43.00
FY 2019	\$296.54	\$104.74	\$401.28	\$15.46
FY 2020	\$266.31	\$102.05	\$368.36	(\$17.46)

* Based on FY 2013 values.

Town of Shrewsbury, Massachusetts
 100 Maple Avenue | Shrewsbury, MA 01545 | www.Shrewsbury-MA.gov





How Have Projected Costs Fared?

Project	Projected High Year Cost	Actual High Year Cost	Difference	FY 2013 Cost
High School*	\$235.93	\$223.46	(5.29%)	\$123.06
Oak MS	\$81.00	\$64.12	(20.84%)	\$40.29
Fire Facilities	\$60.55	\$52.97	(12.52%)	\$43.58
Sherwood MS**	\$150.07	\$139.80	(6.8%)	\$121.45

* Includes additional \$3.4 Million; ** on \$20 Million only

Town of Shrewsbury, Massachusetts

100 Maple Avenue | Shrewsbury, MA 01545 | www.Shrewsbury-MA.gov



Budget Comparisons

	Renovation Only	Chapter 149 Delivery Method	Chapter 149A Delivery Method
Total Project Budget	\$12,800,000	\$21,600,00	\$23,300,000
Less Grant Funding	\$0	\$7,959,989	\$7,959,989
Less Fundraising	\$0	\$1,750,000	\$1,750,000
To Be Borrowed	\$12,800,000	\$11,900,000	\$13,600,000

Town of Shrewsbury, Massachusetts

100 Maple Avenue | Shrewsbury, MA 01545 | www.Shrewsbury-MA.gov



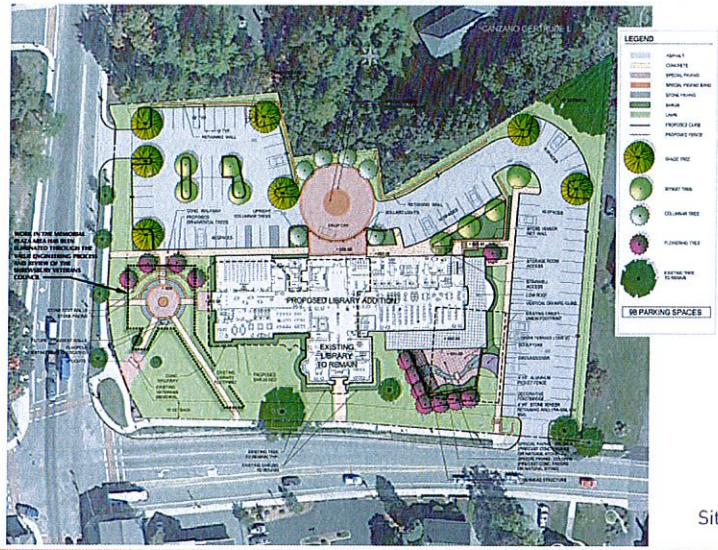

Site Plan

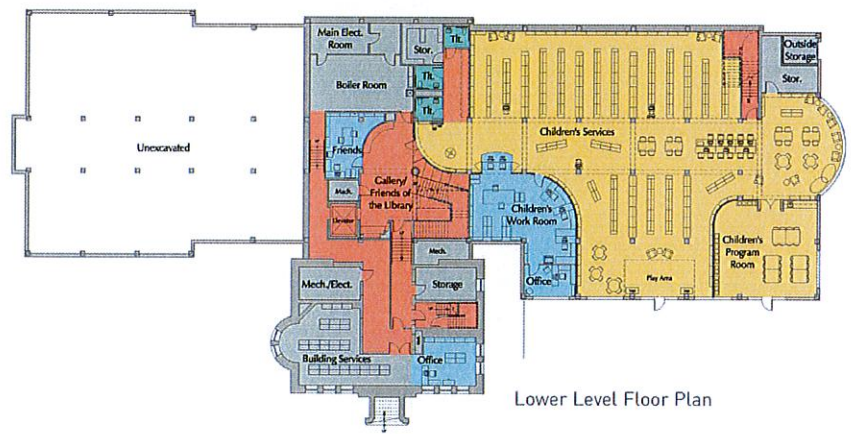

Lower Level Floor Plan

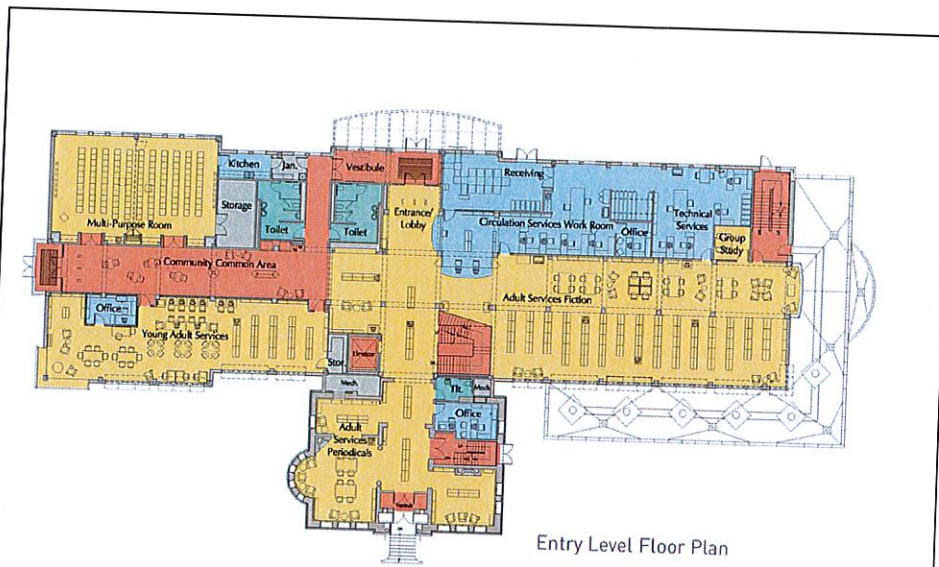

Entry Level Floor Plan



Shrewsbury Public Library

19



LAMOUREUX-PAGANO
ARCHITECTS PROJECT MANAGERS

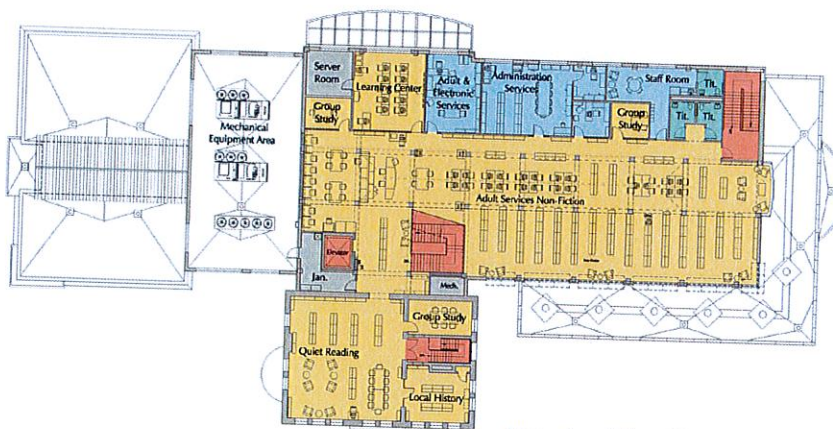

Upper Level Floor Plan



Shrewsbury Public Library

20



LAMOUREUX-PAGANO
ARCHITECTS PROJECT MANAGERS

VIEW FROM LOWER MAIN STREET



SHREWSBURY PUBLIC LIBRARY
SHREWSBURY, MASSACHUSETTS

LAMOUREUX-PAGANO
ARCHITECTS - PROJECT MANAGERS



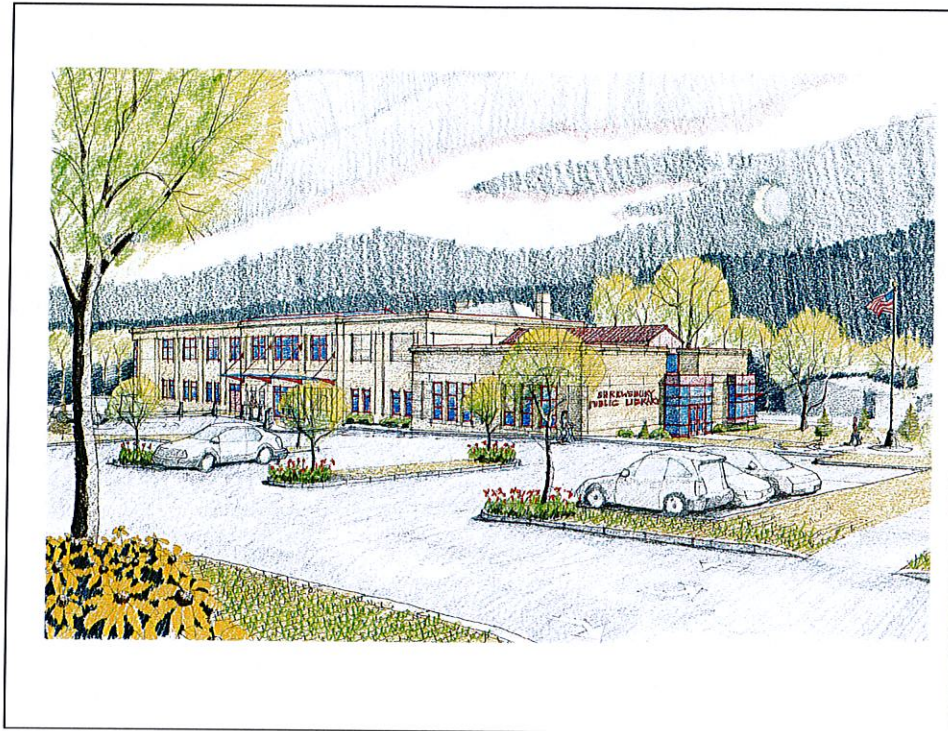

Library Program FY2004 through FY2014

CAPACITIES		EXISTING	2004 GRANT & DESIGN		NEW GRANT AND PROPOSED DESIGN			
		Current Building	2004 Cohen Program	2004 Beacon Design	2010 Godfrey Program	MBLC Program changes	LL+B Design 2010	LPA Design 2013
Collections	Volumes-Adult	68929	87,904	91,854	88,945	SAME	84,577	65,500
	Volumes- Teen	6,761	5,929	6,446	7,200	SAME	6,000	10,000
	Volumes-Children	43,144	58,446	60,037	52,600	SAME	63,315	49,220
	Periodical Subscriptions	211	300	306	300	SAME	300	250
	Media	14,757	15,699	15,747	15,409	SAME	15,000	15,000
	Total Items	133,802						139,970
Seating	Adult seating	94	146	150	90	SAME	92	125
	Teen seating	22	26	26	33	SAME	31	33
	Children's seating	28	54	54	42	SAME	58	49
Public Computers	Adult computers	12	14	14	26	SAME	30	28
	Teen computers	2	4	5	8	SAME	8	8
	Children's Computers	3	10	10	8	SAME	8	8
Parking spaces		48	NA	80	155	103	102	98
Meeting room seats		125	150	150	125	150	150	125
Story hour/activity room seats		0	208	214	24	SAME	24	24
Total Building Square Footage		25,500	50,000	46,626	47,312	41,630	41,339	38,600

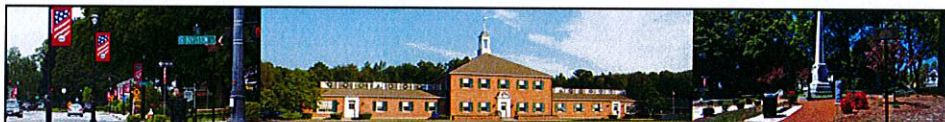
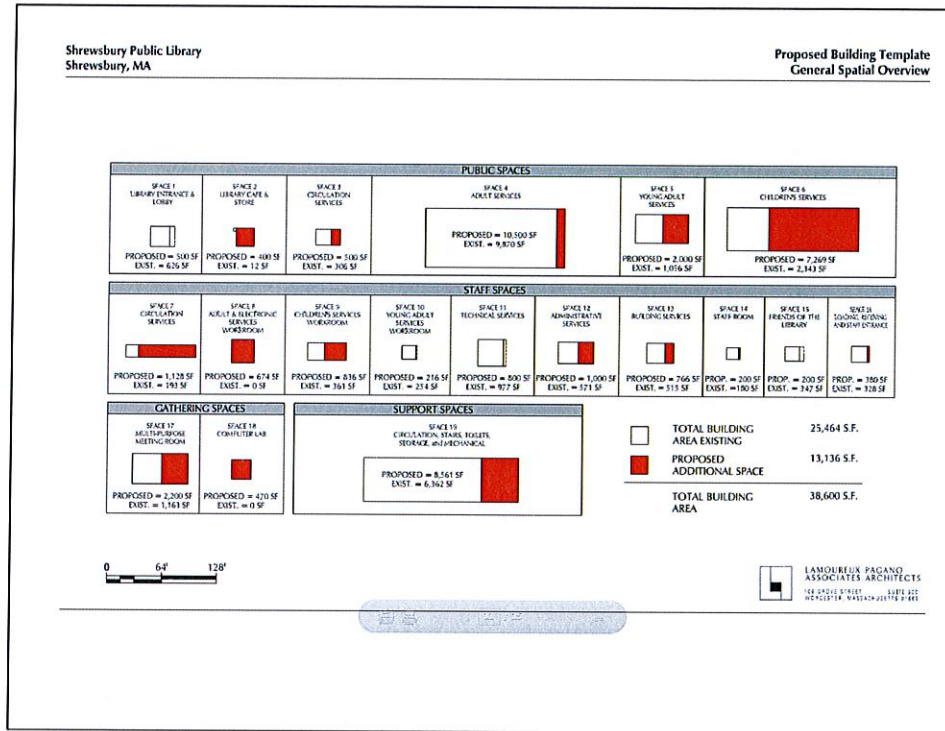

Benefits to schools/students/educators

- Dedicated technology lab/instructional space
- Improved meeting space, with after hours use
- More collaborative workspaces for students
- Improved study and gathering spaces for students of all ages
- Improved technology services and infrastructure
 - More computers, improved Wi-Fi and technology support
- Improved staffing efficiencies
 - Freeing staff to provide more direct service to educators and students
- Funded outside of the levy limit
 - Not drawing funds from school/municipal needs
- Improved teen spaces
 - collection and gathering space combined and accessible, and adjacent to Teen Librarian's office
- Improved services to preschoolers, elementary & middle school students
 - dedicated children's programming room
 - Larger inviting children's area, encouraging use by families and caregivers

Town of Shrewsbury, Massachusetts

100 Maple Avenue | Shrewsbury, MA 01545 | www.Shrewsbury-MA.gov

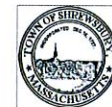



**SHREWSBURY PUBLIC SCHOOLS
SCHOOL COMMITTEE**

**ITEM NO: IV. Time Scheduled Appointment
D. 2013 Enrollment and Class Size: Report**

MEETING DATE: 10/23/13

SPECIFIC STATEMENT OR QUESTION:

Will the School Committee hear a report on the district's enrollment and class size for the current school year, effective October 1, 2013?

BACKGROUND INFORMATION:

1. Each year the district is required to provide a report on enrollment as of October 1 to the Department of Elementary and Secondary Education. An overview of this data will be presented for School Committee review.
2. Dr. Sawyer will present an overview of district-wide enrollment data.
3. Additionally, Mr. Bazydlo and Mr. Nevader will present an overview of Shrewsbury High School class size by department.
4. There are two reports under separate cover: a) the Enrollment and Class Size Report for Preschool – Grade 8, and b) the Class Size Report for Shrewsbury High School

ACTION RECOMMENDED:

That the School Committee accept the report and take whatever steps it deems necessary in the interests of the Shrewsbury Public Schools.

STAFF AVAILABLE FOR PRESENTATION:

Dr. Joseph M. Sawyer, Superintendent
Mr. Todd Bazydlo, Principal, Shrewsbury High School
Mr. Greg Nevader, Assistant Principal, Shrewsbury High School

Shrewsbury Public Schools

Enrollment and Class Size Report Preschool - Grade 8

2013-2014

Data based on enrollment numbers as of October 1, 2013

SHREWSBURY PUBLIC SCHOOLS ENROLLMENT HISTORY

In-District PreK-12 Actual Enrollment: 2004-2013

The chart below illustrates the district's enrollment for the past 10 school years, which reflects growth from 5,713 to 6,014, an increase of 301 students.

PreK-12 Actual Enrollment 2004-2013

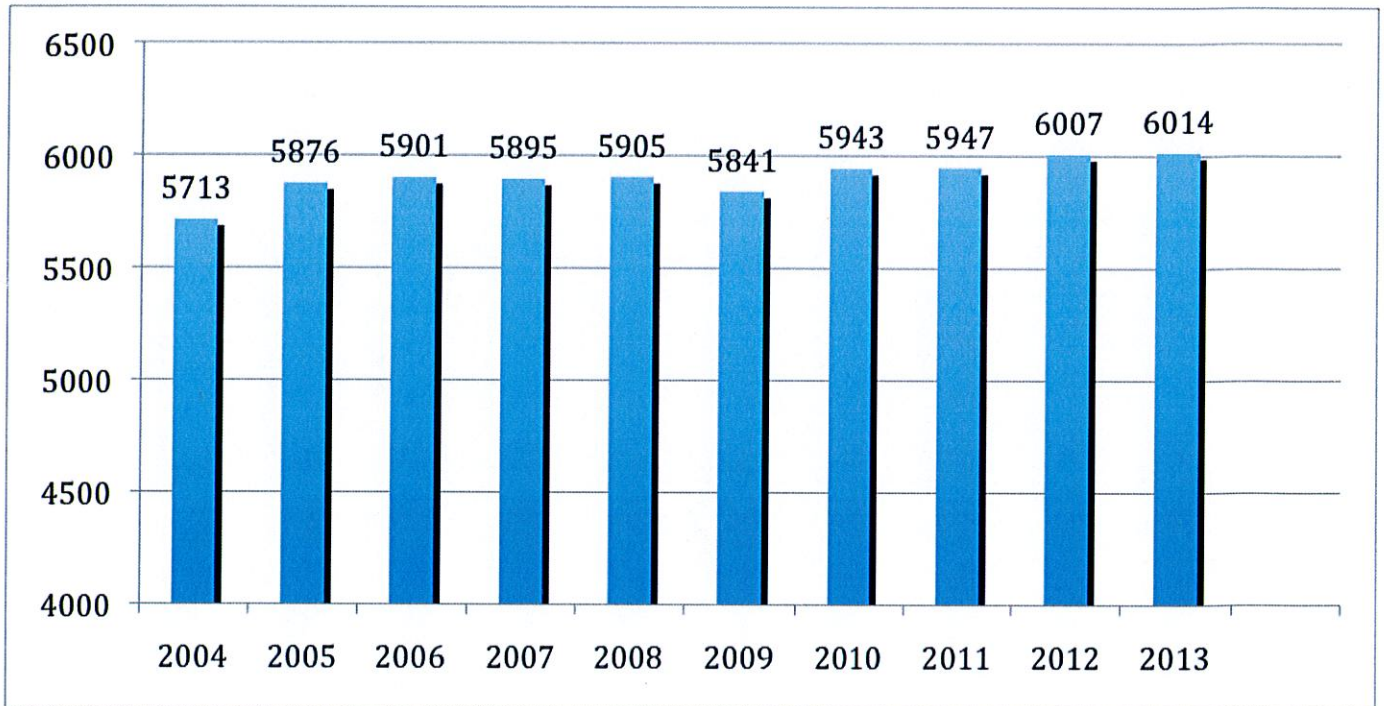

SHREWSBURY PUBLIC SCHOOLS 2013 ENROLLMENT BY GRADE

Enrollment by Grade October 1, 2013

The Department of Elementary and Secondary Education uses enrollment figures as of October 1 of each school year for its official statistics. The in-district populations for each grade in Shrewsbury as of October 1, 2013 are displayed in the chart below:

2013 PreK-12 Enrollment (October 1)



Enrollment History by Grade Level 2004-2013

Grade	2004	2005	2006	2007	2008	2009	2010	2011	2012	2013
PreK	174	188	173	181	196	211	241	243	262	250
K	384	394	378	376	342	348	372	341	364	392
1	449	452	440	439	476	426	429	429	416	399
2	489	466	468	454	456	493	448	457	447	450
3	464	502	452	482	459	465	515	464	474	452
4	504	466	507	454	478	459	472	516	458	480
5	463	502	462	496	456	473	469	485	524	462
6	492	461	488	450	461	436	465	476	465	518
7	444	486	449	485	453	466	435	462	473	490
8	441	443	501	449	489	439	479	443	466	471
9	413	425	408	419	393	421	401	414	408	420
10	360	402	436	404	429	398	417	414	421	406
11	334	345	388	423	390	415	390	413	417	421
12	320	344	351	383	427	391	410	390	412	403
Total P-12	5731	5876	5901	5895	5905	5841	5943	5947	6007	6014
% Annual Change		2.53%	0.43%	-0.10%	0.17%	-1.08%	1.75%	0.07%	1.01%	0.12%

Special Education Out of District Placements

Grade	Pre	K	1	2	3	4	5	6	7	8	9	10	11	12	13*	Total
2009	2	0	3	1	3	5	6	2	7	4	3	6	9	7	13	71
2010	0	0	0	2	3	5	4	5	2	9	3	6	5	7	11	62
2011	1	0	0	0	1	3	7	6	6	2	11	4	9	4	15	69
2012	1	0	0	0	1	1	3	8	6	9	5	10	4	8	22	78
2013	0	1	1	0	1	3	1	2	8	8	7	4	8	5	26	75

*Grade 13 represents students requiring services until age 22.

Note: Some out of district placements are temporary, so totals fluctuate over the course of the year.

Vocational Technical School Enrollment

Grade	9	10	11	12	Total
2009	41	31	37	24	133
2010	34	40	30	35	139
2011	40	29	38	25	132
2012	28	36	31	32	127
2013	37	29	37	28	131

CLASS SIZE AVERAGES: HISTORY

Kindergarten Average Class Size

(School Committee Guidelines 17-19)

	Beal	Coolidge	Spring
2004	19	N/A	N/A
2005	19	N/A	18
2006	19	N/A	18
2007	18	21	16
2008	19	21	18
2009	19	20	20
2010	21	21	19
2011	19	19	18
2012	20	19	21
2013	19	20	20
Avg.	19	20	20

Elementary (1-4) Average Class Size School-Wide

(School Committee Guidelines Gr. 1-2 = 20-22; Gr. 3-4 = 22-24)

	Beal	Coolidge	Floral	Paton	Spring
2004	17	20	23	22	20
2005	17	20	23	23	23
2006	21	21	23	22	20
2007	22	20	23	21	21
2008	22	21	23	21	22
2009	19	22	23	22	21
2010	21	21	23	23	22
2011	22	21	23	23	22
2012	N/A	23	25	23	24
2013	N/A	23	25	23	23
Avg.	21	21	23	22	22

Middle School Average Class Sizes

(School Committee Guidelines Gr. 5-8 = 22-24)

	Grade 5	Grade 6	Grade 7	Grade 8
2004	21	22	22	22
2005	25	23	22	22
2006	26	24	25	28
2007	25	23	24	25
2008	25	23	25	24
2009	24	24	26	22
2010	26	26	24	27
2011	27	26	26	25
2012	29	29	30	29
2013	29	29	31	29
Avg.	26	25	26	25

Elementary Class Size History (Grade 1-4)

B=Beal; C=Coolidge; F=Floral; P=Paton; S=Spring

	Grade 1 (SC 20-22)					Grade 2 (SC 20-22)				Grade 3 (SC 22-24)				Grade 4 (SC 22-24)			
	B	C	F	P	S	C	F	P	S	C	F	P	S	C	F	P	S
2004	17	19	20	20	17	20	21	23	22	22	25	22	22	19	24	22	21
2005	17	21	21	25	20	17	22	21	26	20	24	24	22	21	23	21	23
2006	21	21	22	20	20	20	23	25	20	21	23	20	20	20	24	24	22
2007	22	19	24	22	18	22	23	20	21	20	23	22	22	21	23	21	21
2008	22	23	24	22	23	22	23	22	19	22	22	21	22	20	23	21	23
2009	19	21	22	21	18	23	24	25	22	20	23	24	21	22	22	21	22
2010	21	20	23	22	21	21	22	21	20	24	24	26	24	21	23	23	22
2011	22	17	22	21	20	22	24	23	22	21	23	22	21	25	24	26	25
2012	N/A	20	23	20	25	25	22	21	21	22	25	23	23	29	29	28	29
2013	N/A	19	20	19	22	26	30	21	28	27	25	29	21	24	25	24	24
AVG.	20	20	22	21	20	22	23	22	22	22	24	23	22	22	24	23	23

Year-to-Year Progression Kindergarten to Grade 12

	K	1	2	3	4	5	6	7	8	9	10	11	12	Gr. 1-12 % Change
Class of 2014	2001	2002	2003	2004	2005	2006	2007	2008	2009	2010	2011	2012	2013	
Enrollment	385	442	464	464	466	462	450	453	439	401	414	417	403	-8.8%
Class of 2013	2000	2001	2002	2003	2004	2005	2006	2007	2008	2009	2010	2011	2012	
Enrollment	393	475	483	480	504	502	488	485	489	421	417	413	412	-13.3%
Class of 2012	1999	2000	2001	2002	2003	2004	2005	2006	2007	2008	2009	2010	2011	
Enrollment	359	420	444	442	464	463	461	449	449	393	398	390	390	-7.1%
Class of 2011	1998	1999	2000	2001	2002	2003	2004	2005	2006	2007	2008	2009	2010	
Enrollment	403	466	471	469	488	494	492	486	501	419	429	415	413	-11.4%
Class of 2010	1997	1998	1999	2000	2001	2002	2003	2004	2005	2006	2007	2008	2009	
Enrollment	330	381	395	402	424	428	436	444	443	408	404	390	390	2.4%
Class of 2009	1996	1997	1998	1999	2000	2001	2002	2003	2004	2005	2006	2007	2008	
Enrollment	342	365	365	391	399	419	423	438	441	425	436	423	427	17.0%
Class of 2008	1995	1996	1997	1998	1999	2000	2001	2002	2003	2004	2005	2006	2007	
Enrollment	339	381	400	408	424	433	427	426	437	413	402	388	383	0.5%
Class of 2007	1994	1995	1996	1997	1998	1999	2000	2001	2002	2003	2004	2005	2006	
Enrollment	346	366	375	389	395	394	389	400	395	356	360	345	351	-4.1%
Class of 2006	1993	1994	1995	1996	1997	1998	1999	2000	2001	2002	2003	2004	2005	
Enrollment	285	316	329	340	348	354	352	361	364	343	343	334	344	8.9%
Class of 2005	1992	1993	1994	1995	1996	1997	1998	1999	2000	2001	2002	2003	2004	
Enrollment	264	311	329	327	341	359	356	356	367	324	330	324	320	2.9%
Class of 2004	1991	1992	1993	1994	1995	1996	1997	1998	1999	2000	2001	2002	2003	
Enrollment	281	294	308	327	324	323	330	328	328	290	296	287	289	-1.7%
Class of 2003	1990	1991	1992	1993	1994	1995	1996	1997	1998	1999	2000	2001	2002	
Enrollment	259	303	306	311	308	318	321	331	338	266	280	283	274	-9.6%
Class of 2002	1989	1990	1991	1992	1993	1994	1995	1996	1997	1998	1999	2000	2001	
Enrollment	238	265	259	257	281	281	280	288	291	241	234	245	236	-10.9%

Kindergarten Enrollment Numbers: Full Day/Half Day

Total Kindergarten		Full Day			Half Day		
Year	Enrollment	Sections	Students	Percentage	Sections	Students	Percentage
2001	385	2	36	9%	16	349	91%
2002	407	2	38	9%	20	369	91%
2003	398	2	37	9%	18	361	91%
2004	384	2	33	9%	18	351	91%
2005	394	3	51	13%	18	343	87%
2006	378	3	57	15%	17	321	85%
2007	376	4	80	21%	17	296	79%
2008	342	4	77	23%	14	265	77%
2009	348	5	96	28%	13	252	72%
2010	372	8	166	45%	10	206	55%
2011	341	8	158	46%	10	183	54%
2012	364	15	307	84%	3	57	16%
2013	392	15	318	81%	4	74	19%

Kindergarten Enrollment: Actual versus Town Manager Projections

Kindergarten			
Year	Actual Enrollment	TM Projection	% Difference
2001	385	392	-1.8%
2002	407	428	-4.9%
2003	398	435	-8.5%
2004	384	419	-8.4%
2005	394	414	-4.8%
2006	378	397	-4.8%
2007	376	410	-8.3%
2008	342	362	-5.5%
2009	348	376 (357 modified)	-7.5%
2010	372	336	10.7%
2011	341	312	9.3%
2012	364	299	21.7%*
2013	392	353	11.0%*

*Full day sections increased from 8 to 15 in 2012 allowing for families who desired full day to enroll. This continues in 2013. Tuition for full day kindergarten is \$3,700 annually.

Note: New England School Development Council projection for 2013 was 352 students.

Students Transferring to Private for Grade 9

	03/04	04/05	05/06	06/07	07/08	08/09	09/10	10/11	11/12	12/13
Bancroft							1			1
Boston Latin				1		1	2			
Catholic Memorial							1			
Gann Academy								1		
Holy Name	2	1	1	1		2				1
Hudson Catholic		1								
Lancaster Academy				1						
Notre Dame	3	4	3	5	3	8	5	3	3	6
Phillips Academy				1						
St John's	22	27	16	18	22	38	42	34	35	33
St Mark's								2		2
St Mary's Worc	1		1							
St Peter Marian	1	1		1				2	1	
The Rivers								1		
Whitinsville Christian Academy								1	1	
Worcester Academy	2			1			2			1
Totals	31	34	21	29	25	49	53	44	40	44

PROJECTED ENROLLMENT AND GRADE CONFIGURATION
 (Based on enrollment projections from Town Manager's Office and the New England School Development Council)
 Updated: May 2013

Grade Level	Beal		Coolidge		Floral Street		Paton		Spring Street	
	Students	Clrms/Sect	Students	Sections	Students	Sections	Students	Sections	Students	Sections
HDK*	68	2/4	17							
FDK*	222	11	20	3	21	21	41	2	21	21
Grade 1				77	4	19	196	9	22	81
Grade 2				83	3	28	191	7	27	83
Grade 3				78	3	26	207	8	26	88
Grade 4				87	4	22	204	8	26	94
Totals	2193	15	19	387	17	23	798	32	25	346
*Total K	397									15
										23
										16
										23

Highlighted numbers represent class size averages above School Committee guidelines:
 Kindergarten guideline: 17-19 (16 of 20 sections over guidelines)
 Grades 1-2 guideline: 20-22 (16 of 34 sections over guidelines)
 Grades 3-8 guideline: 22-24 (88 of 104 sections over guidelines)

* Town Manger projection for K = 353; NESDEC Projection for K = 352
 Actual registration as of 5/10/13 = 397
 There will be 4 kindergarten students who will attend a specialized intensive program in-district and are not in figures above

Grade Level	Sherwood Middle		Oak Middle		High School		Preschool Program	
	Students	Sections	Students	Sections	Students	Sections	Program	Cr./Sect.
Grade 5	463	16	29				Parker Rd.	167
Grade 6	518	18	29				Little Col.	30
Grade 7				465	16	29	Wesleyan Terrace	65
Grade 8				476	16	30		2/6
Grade 9								11
Grade 10				413				
Grade 11				414				
Grade 12				413				
				417				
Totals	3579	981	34	941	32	29		262
In-District Total K-12:								12
In-District Total PreK-12:								22

* Town Manager's Projection for K-12 = 5,737
 • NESDEC Projection for K-12 = 5,759; NESDEC Projection for PreK-12 = 6,024

2013-2014
ACTUAL ENROLLMENT and GRADE CONFIGURATION
OCTOBER 1, 2013

Grade Level	Beal			Coolidge			Floral Street			Paton			Spring Street				
	Actual 10/1/13	Students	Clstrms/Sect.	Avg.	Students	Sections	Avg.	Students	Sections	Avg.	Students	Sections	Avg.	Students	Sections	Avg.	
HDK*	74	74	2/4	19	60	3	20	180	9	20	75	4	19	40	2	20	
FDK*	318	218	11	20	77	4	19	207	7	30	83	4	21	67	3	22	
Grade 1	399	77	3	26	77	3	26	202	8	25	88	3	29	83	3	28	
Grade 2	450	80	3	27	95	4	24	196	8	25	94	4	24	82	4	21	
Grade 3	452	95	4	24										95	4	24	
Grade 4	480																
Totals	2173	292	15	19	389	17	23	785	32	25	340	15	23	367	16	23	
*Total K																	

* Town Manger projection for K = 353; NESDEC Projection for K = 352

Highlighted numbers represent class size averages above School Committee guidelines:
 Kindergarten guideline: 17-19 (16 of 20 sections over guidelines)
 Grades 1-2 guideline: 20-22 (16 of 34 sections over guidelines)
 Grades 3-8 guideline: 22-24 (88 of 104 sections over guidelines)

Grade Level	Sherwood Middle			Oak Middle			High School			Preschool Program					
	Projected 2013-14	Students	Sections	Avg.	Students	Sections	Avg.	Students	Sections	Avg.	Program	Students	CR/Sect.	Avg.	
Grade 5	462	462	16	29	490	16	31	420	N/A	N/A	Parker Rd.	160	6/14	12	
Grade 6	518	518	18	29	471	16	29	406	N/A	N/A	Little Col.	28	1/2	15	
Grade 7	490							421	N/A	N/A	Wesleyan Terrace	62	2/6	11	
Grade 8	471							403	N/A	N/A					
Grade 9	420														
Grade 10	406														
Grade 11	421														
Grade 12	403														
Totals	3591	980	34	29	961	32	30	1650	na	N/A		250	11	22	
In-District Total K-12:															
In-District Total PreK-12:															

• Town Manager's Projection for K-12 = 5,737
 • NESDEC Projection for K-12 = 5,759; NESDEC Projection for PreK-12 = 6,024

Totals by Schools 10/1/13	
Preschool	250
Beal	292
Coolidge	389
Floral	785
Paton	340
Spring	367
Sherwood Middle	980
Oak Middle	961
High School	1650
TOTAL ENROLLMENT	6014
TOTALS BY GRADES	
Preschool	250
Kindergarten	392
Grade 1	399
Grade 2	450
Grade 3	452
Grade 4	480
Elementary Sub total	1781
Grade 5	462
Grade 6	518
Grade 7	490
Grade 8	471
Middle School Sub total	1941
Grade 9	420
Grade 10	406
Grade 11	421
Grade 12	403
High School Sub total	1650
TOTAL ENROLLMENT	6014
Out of District Special Education	75
Vocational High School	131
Walk-ins – Special Education	27
TOTAL	233
GRAND TOTAL	6247

Preschool	
PARKER ROAD	10/1/13
Typical	127
General Special Education	24
Intensive Special Education	9
TOTAL	160
LITTLE COLONIALS	
Typical	28
General Special Education	0
Intensive Special Education	0
TOTAL	28
PARKER at WESLEYAN	
Typical	48
General Special Education	14
Intensive Special Education	0
TOTAL	62
Total Typical	203
Total General Special Education	38
Total Intensive Special Education	9
TOTAL PRESCHOOL	250

Beal Early Childhood Center	
KINDERGARTEN AM	10/1/13
Chaves	20
Dumphy	18
TOTAL AM	38
KINDERGARTEN PM	
Chaves	17
Barrett	19
TOTAL PM	36
FULL DAY	
Biadasz	21
Cipro	20
Cornacchioli	20
Costello	20
Downs	19
MacLaughlin	20
McKiernan	19
Middlesworth	20
Pinto	20
Thayer	21
Zakar	18
TOTAL FULL DAY	218
TOTAL SCHOOL	292

Calvin Coolidge School	
Kindergarten	10/1/13
Broszeit	20
McInerny	18
Rubin	20
SPED Intensive Program	2
TOTAL KINDERGARTEN	60
GRADE 1	
Flemming	19
McQuade	18
Mongeon	19
Shepard	19
SPED Intensive Program	2
TOTAL GRADE 1	77
GRADE 2	
Cloyes	23
Hurley	26
Osborne	26
SPED Intensive Program	2
TOTAL GRADE 2	77
GRADE 3	
Burnap	26
Kendrick	26
Lane	26
SPED Intensive Program	2
TOTAL GRADE 3	80
GRADE 4	
Finneran	24
Innamorati	24
Murzycki	24
Weagle	23
TOTAL GRADE 4	95
SCHOOL TOTAL	389

Floral Street School	
GRADE 1	10/1/13
Avery	21
Bradt	20
Frankian	19
Kelly	20
Harrington	19
Marold	20
McGrail	21
Plourde	20
Ward	20
TOTAL GRADE 1	180
GRADE 2	
Beall	29
Caforio	30
Grossman	30
Hogan	30
Martel	30
Poppalardo	29
Richard	29
TOTAL GRADE 2	207
GRADE 3	
Bisceglia	24
Goulding	26
Manning	26
Nolli	24
Peterson	24
Stanwick	26
Suto	26
Ushinski	26
TOTAL GRADE 3	202
GRADE 4	
Edgren	25
Herring	25
Largess	24
Morgan	24
Morrissey	23
Ralys	26
Ross	24
Spangenberg	25
TOTAL GRADE 4	196
SCHOOL TOTAL	785

Walter J. Paton School	
GRADE 1	10/1/13
Catalanotti	20
Halacy	19
Hawley/Kilgore	18
Viscomi	18
TOTAL GR. 1	75
GRADE 2	
Connolly	21
Early	20
Gustafson	21
Symonds	21
TOTAL GR. 2	83
GRADE 3	
Carlson	29
Darling	29
Kalagher	30
TOTAL GR. 3	88
GRADE 4	
Camerato	23
Cormier	24
Leifer	23
Moran	24
TOTAL GR. 4	94
SCHOOL TOTAL	340

Spring Street School	
Kindergarten	10/1/13
Camerato	20
Silver	20
TOTAL K	40
GRADE 1	
Baumann	22
Kinback	22
Lewis	23
TOTAL GRADE 1	67
GRADE 2	
Fraher	28
Porter	27
Rice	28
TOTAL GRADE 2	83
GRADE 3	
Garabedian	20
McRae	21
Tolczko	20
Tougher	21
TOTAL GRADE 3	82
GRADE 4	
Doherty	24
Liporto	23
Luby	24
Travers	24
TOTAL GR. 4	95
SCHOOL TOTAL	367

Sherwood Middle School	
GRADE 5	10/1/13
Blash	29
Carney	29
Chalmers	30
D'Ascanio	29
Donahue	29
Gouley	29
Lavery	29
Marcigliano	29
Martin	29
Matthews	28
McCabe	28
McCarthy	29
Nolle	28
O'Neil	29
Ryan	29
Virzi	29
TOTAL GRADE 5	462
GRADE 6	
Andrews	29
Broderick	29
Cristy	28
DiGiacomo	28
Duggan	29
Egan	30
Goudreau	29
Graham	29
Lipkin	29
Macchi	29
Middlesworth	29
Polechronis	27
Rekemeyer	28
Shamey	28
Siegman	29
Stoychoff	29
Tinsley	30
Walsh	29
TOTAL GRADE 6	518
SCHOOL TOTAL	980

Oak Middle School	
GRADE 7	10/1/13
Amdur	30
Beaupre	31
Binder	30
Davis	32
DePalo	30
Dolen	31
Dowd	30
Goddard	31
Hadavi	30
Johnson	32
McCabe	32
McGrath	30
Pruett	30
Scibelli	30
Sloan	30
Suri	31
TOTAL GRADE 7	490
GRADE 8	
Ahlin	30
Crosby	26
DeNolf	30
Dufault	30
Dunn	31
Egan	29
Kewriga	31
Knox	30
LaValley	29
Lewis	30
Militello	28
Mularella	29
Mulcahy	31
O'Connor	28
Pizzuto	28
Ponticelli	31
TOTAL GRADE 8	471
SCHOOL TOTAL	961

Shrewsbury High School

Shrewsbury, MA



Class Size Report 2013-2014

**Data based on enrollment numbers as of
October 1, 2013**

Shrewsbury High School Class Size Report - October 2013

This report is based on data from the week of October 1, 2013. It contains information on class size and student enrollment for the first and second semesters of the 2013-2014 school year.

Overall Enrollment

High school enrollment has remained consistent for the past several years with this year's enrollment decreasing by nine students compared to 2012-2013. The charts below show the nine-year enrollment trend for the high school both in the aggregate and by grade.

Enrollment 2005-06 through 2013-14

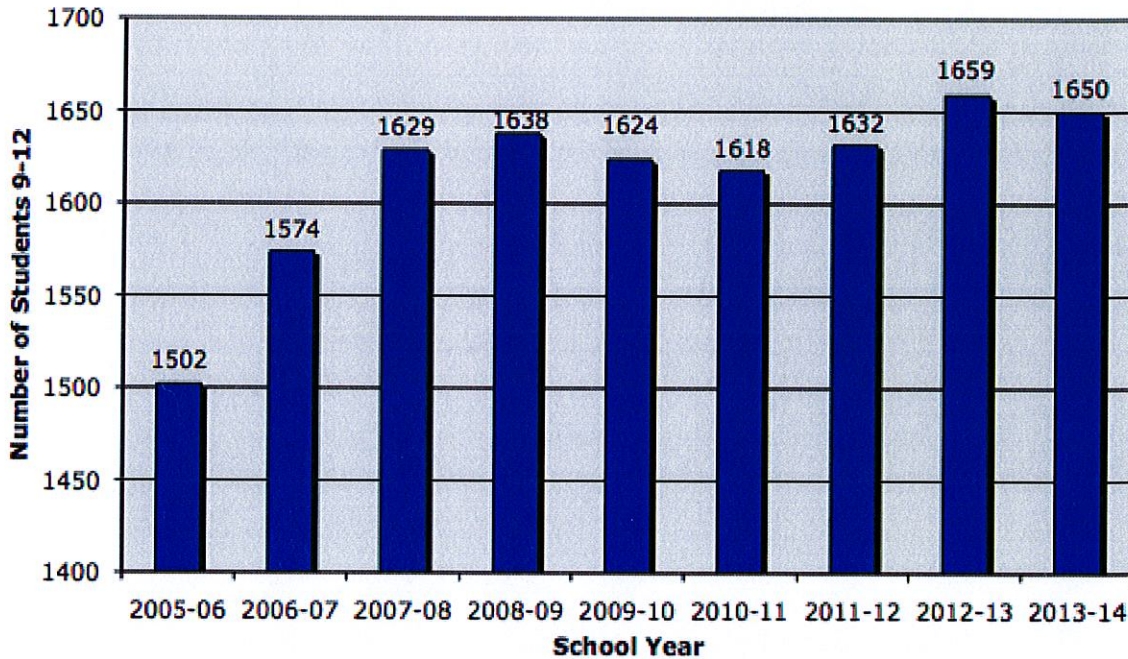

Grade	05-06	06-07	07-08	08-09	09-10	10-11	11-12	12-13	13-14
9	425	407	419	393	421	401	414	408	420
10	402	435	404	429	398	417	414	422	406
11	346	387	423	390	415	390	413	417	421
12	329	345	383	426	390	410	391	412	403
Total	1502	1574	1629	1638	1624	1618	1632	1659	1650

Staffing and Full-Time Equivalency (FTEs)

Compared to last year, the high school had a net increase of .4 FTEs in foreign language as a result of the addition of FTE to meet student enrollment demands. Despite having the second highest enrollment on record, the high school has reduced teaching staff by 6.2 FTEs over the past five years. The core academic subjects (English, math, social science, foreign language, and science) have been impacted the most during this time with a total reduction of 5.2 FTEs.

Staffing (FTEs) by Department						
Department--All	09-10	10-11	11-12	12-13	13-14	5-Year Diff.
English	15.4	14.4	14.4	13.4	13.4	-2.0
Family & Consumer Science	3.0	3.0	3.0	3.0	3.0	-
Foreign Language	10.8	10.4	10.8	10.6	11.0	+4
Health & Phys. Ed.	6.6	6.6	6.6	8.6*	8.6*	+2.0
ITAMS	2.0	2.0	1.8	1.8	2.0	-
Math	14.8	14.8	14.8	13.8	13.8	-1.0
Music	2.1	2.1	2.1	2.1	2.1	-
Science	14.0	14.0	14.0	13.4	13.4	-.6
Social Science	14.2	13.2	13.4	12.4	12.4	-1.8
Special Programs (VHS)	0.2	0.2	0.2	0.2	0.2	-
Technology	1.2	1.2	1.2	1.2	1.2	-
Visual Art	4.4	4.4	4.4	3.4	3.4	-1.0
English Language Education	1.4	1.6	1.2	1.2	1.2	-.2
Total FTE	90.1	87.9	87.9	83.1	83.7	-6.2
* = 2.0 FTEs added as the result of the Physical Education Program (PEP) Grant and are <u>not</u> included in the total FTEs listed above						
9 - 12 Enrollment	1624	1618	1632	1659	1649	-10

Staffing (FTEs) by Academic Department						
Department--All	09-10	10-11	11-12	12-13	13-14	5-Year Trend
English	15.4	14.4	14.4	13.4	13.4	-2.0
Social Science	14.2	13.2	13.4	12.4	12.4	-1.8
Math	14.8	14.8	14.8	13.8	13.8	-1.0
Science	14.0	14.0	14.0	13.4	13.4	-.6
Foreign Language	10.8	10.4	10.8	10.6	11.0	+2
Academic FTEs Total	69.2	66.8	67.4	63.6	64.0	-5.2
9 - 12 Enrollment	1624	1618	1632	1659	1649	+25
Average Academic Student-to-Teacher Ratio	23.5	24.2	24.2	26.1	25.8	+2.3

Teacher Caseloads and Class Enrollment

The vast majority of SHS teachers are responsible for a caseload of between 110 and 135 students (22-27 students per section). The following table reveals the number of core academic sections significantly over-enrolled by department for the second consecutive year.

Dept.	Total # Sections			# Sections 27+			% Over-Enrolled		
	11-12	12-13	13-14	11-12	12-13	13-14	11-12	12-13	13-14
English	74	67	67	6	20	19	8%	30%	28%
For. Lang.	54	53	55	10	19	12	19%	36%	22%
Health	36	52	52	0	25	26	0%	48%	50%
Math	74	69	69	21	17	22	28%	25%	32%
Science	73	71	73	37*	50*	53*	50%	70%	73%
Soc. Sci.	74	70	69	22	36	33	30%	51%	48%
TOTALS	385	382	385	96	167	165	25%	44%	43%

*Maximum enrollment in science sections is 24

School Committee Guidelines

School Committee guidelines recommend class sizes of 18-20 at the high school level. The chart below reveals that 86% of the sections in the core academic subjects of English, math, science, social science, and foreign language exceed these guidelines. In order for these disciplines to fall within the recommended School Committee guidelines, a total of an additional 13.8 FTEs are necessary.

Dept.	Total # of sections	# of sections exceeding School Committee guidelines	% of sections exceeding School Committee guidelines	# of FTEs required to fall within School Committee guidelines
English	67	59	88.1%	2.4
For. Lang.	52	39	75.0%	2.2
Math	69	52	75.4%	2.2
Science	73	64	87.7%	4.0
Soc. Sci.	69	64	92.8%	3.0
TOTALS	278	239	86.0%	13.8

Average Class Size by Department

Compared to last year, average class size slightly decreased in seven out of the eleven departments. The small reduction in these numbers can be attributed to efficiencies created within the master schedule. At the same time, however, the average class size is at an all-time high in four departments.

Average Class Size by Department 2008-09 through 2013-2014						
Department	09-10	10-11	11-12	12-13	13-14	Range 13-14
English	20.3	21.8	22.3	23.7	23.9	10-29
Family & Consumer Science	20.0	19.6	20.0	22.6	21.6	12-24
Foreign Language	22.6	23.5	22.2	23.6	22.3	11-30
Health	23.6	22.6	23.6	24.2	24.2	15-30
Instructional Technology	19.8	19.3	19.1	20.0	16.0	11-24
Mathematics	21.3	22.1	22.3	23.9	23.5	9-30
Physical Education	23.6	22.9	23.5	25.1	24.3	7-32
Science	23.3	22.7	22.9	24.4	24.2	7-31
Social Sciences	22.1	24.2	24.1	25.9	25.8	11-30
Technology Education	19.1	20.5	19.4	20.8	21.6	19-25
Visual Arts	18.0	18.9	19.1	18.8	19.6	12-25

Guidance

The average student-to-counselor ratio remains unchanged this year at 259:1. This ratio has not changed significantly since the addition of 1.0 FTE in guidance in the 2008-09 school year; however, as enrollment continues to increase, average counselor caseloads will increase accordingly. A complete listing of guidance counselor caseloads can be found in the guidance department section of this report.

Lab Sciences

Class sizes in lab science courses remain one of our biggest concerns. National laboratory safety standards recommend that lab science courses have no more than 24 students enrolled. We currently have 53 out of 73 sections (73%) above this limit. Because of overcrowding in science classes, we are again unable to accommodate requests from students to enroll in two full-year science courses in one year. This limitation was put in place seven years ago. Additional FTEs would be necessary to fulfill these requests. The same need is present in mathematics as well, although to a lesser degree.

Student Internships and Independent Studies

Students continue to enroll in school-based internships and independent studies for credit during what would otherwise be study periods. These opportunities have helped mitigate the overall study hall numbers. School-based internships include office internships, which involve clerical duties (e.g. answering telephones, filing, reception) as well as academic internships where students work as teaching assistants in certain classrooms and provide clerical support to department directors. Independent studies are often project-based and involve a contract between an individual student and a single teacher. Enrollments for 2013-2014 are as follows:

Internships	2012-13	2013-14
Program	# Students	# Students
Athletic Internship	12	7
Custodial Internship	0	0
Early Childhood Internship	1	2
Family and Consumer Science	0	2
English Internship	12	10
Foreign Language Internship	11	6
Guidance Internship	18	10
ITAMS Internship	0	2
Math Internship	9	15
Media Internship	0	2
Music Internship	3	0
Office Internship	28	22
Physical Education Internship	3	2
Science Internship	4	5
Social Science Internship	4	2
Special Education Internship	5	2
Tutoring Lab Internship	33	28
Visual Arts Internship	6	2
Total	144	119
Independent Studies		
Program	# Students	# Students
Music	3	0
ITAMS	6	1
Senior Exhibition	8	3
Total	17	4



Enrollment by Department

**Class Size Report
2013-2014**

Shrewsbury High School
English Language Education

October 1, 2013

ELE					
	FTE	# of Sections	# of Students	Avg. Class Size	
Murray	0.4	2	12	6.0	
Nattinville	0.8	4	30	7.5	
Total	1.2	6	42	7.0	
Last Name	Course Name	Term	Section Number	Class Size	Average Class Size
Murray	ELE American Culture & History I & II	FY 13-14	1	8	8.0
Nattinville	ELE English I	FY 13-14	1	1	1.0
Murray	ELE English II	FY 13-14	1	4	4.0
Nattinville	ELE English III	FY 13-14	2	5	5.0
Nattinville	ELE English IV	FY 13-14	1	5	5.0
Nattinville	ELE Academic Support	FY 13-14	1	19	19.0

**Class Size Report
2013-2014**

English Department

October 1, 2013

English	FTE	# of Sections	# of Students	Avg. Class Size
Brown-Dolan	1.0	5	113	22.6
Burnett	1.0	5	97	19.4
Cacela	1.0	5	133	26.6
Trombley	0.4	2	58	29.0
DePalo	1.0	5	128	25.6
DePeter	1.0	5	119	23.8
Hall	1.0	5	124	24.8
Jha	1.0	5	114	22.8
MacDonald	1.0	5	115	23.0
Palazzo	1.0	5	127	25.4
Penfield	1.0	5	130	26.0
Secino	1.0	5	112	22.4
Steinberg	1.0	5	103	20.6
Yellin	1.0	5	125	25.0
Total	13.4	67	1598	23.9

Teacher	Course Name	Term	Section Number	Class Size	Average Class Size
Burnett	English 9B	FY 13-14	2	12	
Burnett	English 9B	FY 13-14	1	10	11.0
Burnett	English 9A	FY 13-14	2	26	
DePeter	English 9A	FY 13-14	8	25	
DePeter	English 9A	FY 13-14	3	24	
DePeter	English 9A	FY 13-14	4	25	
Hall	English 9A	FY 13-14	7	27	
Hall	English 9A	FY 13-14	9	25	
MacDonald	English 9A	FY 13-14	5	22	
MacDonald	English 9A	FY 13-14	6	21	
Yellin	English 9A	FY 13-14	1	24	24.3
DePalo	English 9 Honors	FY 13-14	6	27	
DePalo	English 9 Honors	FY 13-14	5	29	
Jha	English 9 Honors	FY 13-14	3	26	
Jha	English 9 Honors	FY 13-14	4	29	
Trombley	English 9 Honors	FY 13-14	2	29	
Trombley	English 9 Honors	FY 13-14	1	29	28.2
Steinberg	English 10B	FY 13-14	1	23	23.0
Cacela	English 10A	FY 13-14	2	21	
Cacela	English 10A	FY 13-14	1	27	
Hall	English 10A	FY 13-14	6	26	
Palazzo	English 10A	FY 13-14	8	22	
Penfield	English 10A	FY 13-14	3	22	
Penfield	English 10A	FY 13-14	4	26	
Steinberg	English 10A	FY 13-14	7	19	
Steinberg	English 10A	FY 13-14	5	23	23.3
Brown-Dolan	English 10 Honors	FY 13-14	2	27	
Brown-Dolan	English 10 Honors	FY 13-14	3	25	
Burnett	English 10 Honors	FY 13-14	5	27	
Burnett	English 10 Honors	FY 13-14	6	22	
Cacela	English 10 Honors	FY 13-14	7	29	

**Class Size Report
2013-2014**

English Department

October 1, 2013

Teacher	Course Name	Term	Section Number	Class Size	Average Class Size
Penfield	English 10 Honors	FY 13-14	4	29	
Penfield	English 10 Honors	FY 13-14	1	27	26.6
Hall	English 11: American Studies & Honors	FY 13-14	3	24	
Hall	English 11: American Studies & Honors	FY 13-14	4	22	
Yellin	English 11: American Studies & Honors	FY 13-14	1	26	
Yellin	English 11: American Studies & Honors	FY 13-14	2	25	24.3
Brown-Dolan	English 11A	FY 13-14	4	21	
DePeter	English 11A	FY 13-14	2	21	
Penfield	English 11A	FY 13-14	5	26	
Steinberg	English 11A	FY 13-14	3	21	
Steinberg	English 11A	FY 13-14	1	17	21.2
DePalo	English 11 Honors	FY 13-14	2	26	
DePalo	English 11 Honors	FY 13-14	1	23	
DePeter	English 11 Honors	FY 13-14	3	24	
Secino	English 11 Honors	FY 13-14	5	19	
Secino	English 11 Honors	FY 13-14	6	25	
Secino	English 11 Honors	FY 13-14	4	23	23.3
Brown-Dolan	AP English Language	FY 13-14	2	20	
Brown-Dolan	AP English Language	FY 13-14	3	20	
Palazzo	AP English Language	FY 13-14	1	23	21.0
Yellin	English 12: Social Issues in World Lit.	FY 13-14	2	24	
Yellin	English 12: Social Issues in World Lit.	FY 13-14	1	26	
Jha	English 12: Literature & Cont. Media	FY 13-14	1	26	
Jha	English 12: Literature & Cont. Media	FY 13-14	2	16	
MacDonald	English 12: Literature & Cont. Media	FY 13-14	3	14	
DePalo	English 12: Literature & the Humanities	FY 13-14	1	23	21.5
Secino	English 12 Honors: Dramatic Literature**	FY 13-14	1	22	
MacDonald	English 12 Honors: Lit. & Cont. Media	FY 13-14	2	29	
MacDonald	English 12 Honors: Lit. & Cont. Media	FY 13-14	1	29	
Cacela	English 12 Honors: Literature Humanities	FY 13-14	2	28	
Cacela	English 12 Honors: Literature Humanities	FY 13-14	1	28	
Jha	English 12 Honors: Romant./Gothic Lit.**	FY 13-14	1	17	
Palazzo	English 12 Honors: Social Iss/World Lit.	FY 13-14	3	27	
Palazzo	English 12 Honors: Social Iss/World Lit.	FY 13-14	1	28	
Palazzo	English 12 Honors: Social Iss/World Lit.	FY 13-14	2	27	26.1
Secino	AP English Literature	FY 13-14	1	23	23.0

**These classes are offered at combined levels (A level and Honors)

**Class Size Report
2013-2014**

Shrewsbury High School
Family and Consumer Science

October 1, 2013

Family and Consumer Science					
	FTE	# of Sections	# of Students	Avg. Class Size	
Brunell	1.0	10	227	22.7	
Crosson	1.0	8	144	18.0	
Early	1.0	10	234	23.4	
Total	3.0	28	605	21.6	
Last Name	Course Name	Term	Section Number	Class Size	Average Class Size
Crosson	Child Development I	S1	2	23	
Crosson	Child Development I	S1	3	24	
Crosson	Child Development I	S1	4	24	
Crosson	Child Development I	S2	1	23	23.5
Crosson	Child Development II	S2	2	20	
Crosson	Child Development II	S2	1	24	22.0
Crosson	*Early Childhood Education & Honors	FY 13-14	1	17	
Crosson	*Early Childhood Education & Honors	FY 13-14	2	12	14.5
Early	Interior Design	S1	1	24	
Early	Interior Design	S2	2	24	24.0
Brunell	Focus on Foods	S1	8	24	
Brunell	Focus on Foods	S1	7	23	
Brunell	Focus on Foods	S1	6	24	
Early	Focus on Foods	S1	1	24	
Early	Focus on Foods	S1	2	24	
Brunell	Focus on Foods	S2	10	22	
Brunell	Focus on Foods	S2	9	24	
Early	Focus on Foods	S2	4	24	
Early	Focus on Foods	S2	3	24	
Early	Focus on Foods	S2	5	22	23.5
Brunell	Mediterranean Cuisine	S1	3	22	
Early	Mediterranean Cuisine	S1	1	23	
Early	Mediterranean Cuisine	S1	2	21	
Brunell	Mediterranean Cuisine	S2	6	24	
Brunell	Mediterranean Cuisine	S2	5	24	
Early	Mediterranean Cuisine	S2	4	24	23.0
Brunell	Culinary Methods for Nutritious Foods	S1	1	17	
Brunell	Culinary Methods for Nutritious Foods	S2	2	23	20.0

**These classes are offered at combined levels.

**Class Size Report
2013-2014**

Shrewsbury High School
Foreign Language

October 1, 2013

Foreign Language					
	FTE	# of Sections	# of Students	Avg. Class Size	
SPANISH:					
Almeida	1.0	5	107	21.4	
Babigian	1.0	5	122	24.4	
Del Toro-Cournoyer	1.0	5	113	22.6	
Ernest	1.0	5	139	27.8	
Montalvo	1.0	5	114	22.8	
Vigneaux	1.0	5	126	25.2	
Total Spanish:	6.0	30	721	24.0	
FRENCH:					
Arnold	0.8	4	79	19.8	
Murphy	1.0	5	93	18.6	
Plourde	1.0	5	101	20.2	
Total French:	2.8	14	273	19.5	
LATIN:					
Bellemer	0.4	2	44	22.0	
Honig	0.2	1	30	30.0	
Thompson	1.0	5	94	18.8	
Total Latin:	1.6	8	168	21.0	
MANDARIN CHINESE:					
Xin	0.6	3	64	21.3	
Total Foreign Language	11.0	55.0	1226	22.3	
Last Name	Course Name	Term	Section Number	Class Size	Average Class Size
Ernest	Spanish I	FY 13-14	3	29	
Montalvo	Spanish I	FY 13-14	1	25	
Montalvo	Spanish I	FY 13-14	2	29	27.7
Almeida	Spanish II A	FY 13-14	1	20	
Babigian	Spanish II A	FY 13-14	2	26	
Babigian	Spanish II A	FY 13-14	3	26	
Vigneaux	Spanish II A	FY 13-14	6	21	
Vigneaux	Spanish II A	FY 13-14	5	28	
Vigneaux	Spanish II A	FY 13-14	4	28	24.8
Almeida	Spanish II B	FY 13-14	2	18	
Almeida	Spanish II B	FY 13-14	1	25	
Del Toro-Cournoyer	Spanish II B	FY 13-14	5	19	
Del Toro-Cournoyer	Spanish II B	FY 13-14	4	27	
Ernest	Spanish II B	FY 13-14	6	23	
Vigneaux	Spanish II B	FY 13-14	3	24	22.7
Babigian	Spanish III	FY 13-14	1	29	
Babigian	Spanish III	FY 13-14	2	29	
Ernest	Spanish III	FY 13-14	3	30	
Ernest	Spanish III	FY 13-14	5	29	
Ernest	Spanish III	FY 13-14	4	28	29.0

**Class Size Report
2013-2014**

Shrewsbury High School
Foreign Language

October 1, 2013

Last Name	Course Name	Term	Section Number	Class Size	Average Class Size
Almeida	Spanish III Honors	FY 13-14	2	21	
Almeida	Spanish III Honors	FY 13-14	1	23	22.0
Montalvo	Spanish IV	FY 13-14	3	19	
Montalvo	Spanish IV	FY 13-14	4	21	
Montalvo	Spanish IV	FY 13-14	2	20	
Vigneaux	Spanish IV	FY 13-14	1	25	21.3
Del Toro-Cournoyer	Spanish IV Honors	FY 13-14	2	21	
Del Toro-Cournoyer	Spanish IV Honors	FY 13-14	1	24	22.5
Babigian	**Spanish V & V Honors	FY 12-13	1	12	12.0
Del Toro-Cournoyer	AP Spanish Language	FY 13-14	1	22	22.0
Arnold	French I	FY 13-14	1	19	19.0
Murphy	French II A	FY 13-14	3	19	
Murphy	French II A	FY 13-14	1	20	
Murphy	French II A	FY 13-14	2	21	20.0
Plourde	French II B	FY 13-14	1	19	19.0
Plourde	French III	FY 13-14	2	22	
Plourde	French III	FY 13-14	1	21	21.5
Arnold	French III Honors	FY 13-14	1	29	29.0
Arnold	French IV	FY 13-14	2	17	
Arnold	French IV	FY 13-14	1	14	15.5
Plourde	French IV Honors	FY 13-14	2	20	
Plourde	French IV Honors	FY 13-14	1	19	19.5
Murphy	**French V & V Honors	FY 13-14	1	18	18.0
Murphy	AP French Language	FY 13-14	1	15	15.0
Honig	Latin I	FY 13-14	1	30	30.0
Bellemer	Latin II	FY 13-14	1	25	
Bellemer	Latin II	FY 13-14	2	19	22.0
Thompson	**Latin III & III Honors	FY 13-14	1	21	
Thompson	**Latin III & III Honors	FY 13-14	2	24	22.5
Thompson	Latin IV Honors	FY 13-14	1	20	
Thompson	Latin IV Honors	FY 13-14	2	18	19.0
Thompson	**AP Latin & Latin V Honors	FY 13-14	1	11	11.0
Xin	Mandarin Chinese II	FY 13-14	1	20	20.0
Xin	**Mandarin Chinese III & III Honors	FY 13-14	1	19	19.0
Xin	**Mandarin Chinese IV/V & IV/V Hon	FY 13-14	1	25	25.0

Case Loads
2013 - 2014

Guidance Counselor	Class of 2017	Class of 2016	Class of 2015	Class of 2014	FTE	2011 - 2012 Totals	2012 - 2013 Totals	2013 - 2014 Totals
Diamantopoulos	61	68	66	65	1.0	241	264	259
Eriole	58	65	68	65	1.0	252	254	255
Floyd	63	69	62	68	1.0	136	261	261
Huynh (Director)	26	28	27	24	.4	n/a	93	104
Lussier	74	48	67	70	1.0	252	265	258
O'Connor	59	69	64	64	1.0	246	259	255
Rice	58	75	60	67	1.0	255	263	259
Totals	408	422	417	412	6.4	1632	1659	1651

**Annual Ratios of
Students-to-Guidance Counselors**

2013-2014 Ratio = 259-to-1
 2012-2013 Ratio = 259-to-1
 2011-2012 Ratio = 255-to-1
 2010-2011 Ratio = 253-to-1
 2009-2010 Ratio = 254-to-1
 2008-2009 Ratio = 256-to-1
 2007-2008 Ratio = 302-to-1

**Class Size Report
2013-2014**

Shrewsbury High School
Health and Physical Education

October 1, 2013

Health and Physical Education					
Physical Education	FTE	# of Sections	# of Students	Avg. Class Size	
Butterfield	1.0	22	553	25.1	
Krause	1.0	22	482	21.9	
Toti	1.0	22	521	23.7	
Wheeler	1.0	22	581	26.4	
McNally	1.0	22	514	23.4	
Bertoni	1.0	22	509	23.1	
Total	6.0	88	2137	24.3	
Health	FTE	# of Sections	# of Students	Avg. Class Size	
Ferris	0.6	20	491	24.6	
Hickey	1.0	12	263	21.9	
Morin	1.0	20	502	25.1	
Total	2.6	52	1256	24.2	
Last Name	Course Name	Term	Section Number	Class Size	Average Class Size
Bertoni	PE-Team	S1	4	27	
Bertoni	PE-Team	S1	6	30	
Butterfield	PE-Team	S1	1	28	
Butterfield	PE-Team	S1	2	28	
Butterfield	PE-Team	S1	3	29	
Butterfield	PE-Team	S1	5	29	
Butterfield	PE-Team	S1	7	29	
Butterfield	PE-Team	S1	8	26	
Butterfield	PE-Team	S1	9	30	
Butterfield	PE-Team	S1	10	31	
Butterfield	PE-Team	S1	11	34	
Bertoni	PE-Team	S2	19	30	
Bertoni	PE-Team	S2	20	31	
Bertoni	PE-Team	S2	21	32	
Bertoni	PE-Team	S2	22	30	
Butterfield	PE-Team	S2	12	28	
Butterfield	PE-Team	S2	13	29	
Butterfield	PE-Team	S2	14	30	
Butterfield	PE-Team	S2	15	27	
Butterfield	PE-Team	S2	16	27	
Butterfield	PE-Team	S2	17	30	
Butterfield	PE-Team	S2	18	32	29.4
Toti	PE-Adventure	S1	13	26	
Toti	PE-Adventure	S1	14	24	
Toti	PE-Adventure	S1	15	21	

**Class Size Report
2013-2014**

Shrewsbury High School
Health and Physical Education

October 1, 2013

Last Name	Course Name	Term	Section Number	Class Size	Average Class Size
Toti	PE-Adventure	S1	16	25	
Toti	PE-Adventure	S1	17	22	
Toti	PE-Adventure	S1	18	18	
Toti	PE-Adventure	S1	19	25	
Toti	PE-Adventure	S1	20	21	
Toti	PE-Adventure	S1	22	26	
Wheeler	PE-Adventure	S1	12	25	
Wheeler	PE-Adventure	S1	21	26	
Toti	PE-Adventure	S2	1	16	
Toti	PE-Adventure	S2	2	25	
Toti	PE-Adventure	S2	3	27	
Toti	PE-Adventure	S2	4	30	
Toti	PE-Adventure	S2	6	19	
Toti	PE-Adventure	S2	7	26	
Toti	PE-Adventure	S2	8	17	
Toti	PE-Adventure	S2	10	21	
Toti	PE-Adventure	S2	11	23	
Wheeler	PE-Adventure	S2	5	26	
Wheeler	PE-Adventure	S2	9	29	23.5
Wheeler	PE - Adventure II	S1	6	22	
Wheeler	PE - Adventure II	S1	7	26	
Wheeler	PE - Adventure II	S1	8	27	
Wheeler	PE - Adventure II	S1	5	22	
Wheeler	PE - Adventure II	S1	4	24	
Wheeler	PE - Adventure II	S1	3	19	
Wheeler	PE - Adventure II	S1	2	16	
Wheeler	PE - Adventure II	S1	1	28	
Wheeler	PE - Adventure II	S2	18	25	
Wheeler	PE - Adventure II	S2	17	27	
Wheeler	PE - Adventure II	S2	16	31	
Wheeler	PE - Adventure II	S2	15	23	
Wheeler	PE - Adventure II	S2	14	30	
Wheeler	PE - Adventure II	S2	13	24	
Wheeler	PE - Adventure II	S2	12	18	
Wheeler	PE - Adventure II	S1	9	23	
Wheeler	PE - Adventure II	S2	10	15	
Wheeler	PE - Adventure II	S2	11	16	23.1
Bertoni	PE-Lifetime	S1	1	28	
Bertoni	PE-Lifetime	S1	3	26	
Bertoni	PE-Lifetime	S1	5	25	
Bertoni	PE-Lifetime	S1	7	28	
Bertoni	PE-Lifetime	S1	8	26	
Bertoni	PE-Lifetime	S1	9	29	
Bertoni	PE-Lifetime	S1	10	30	
McNally	PE-Lifetime	S1	2	28	

**Class Size Report
2013-2014**

Shrewsbury High School
Health and Physical Education

October 1, 2013

Last Name	Course Name	Term	Section Number	Class Size	Average Class Size
McNally	PE-Lifetime	S1	4	26	
McNally	PE-Lifetime	S1	6	28	
McNally	PE-Lifetime	S1	11	30	
Bertoni	PE-Lifetime	S2	12	26	
Bertoni	PE-Lifetime	S2	13	28	
Bertoni	PE-Lifetime	S2	15	29	
Bertoni	PE-Lifetime	S2	16	27	
Bertoni	PE-Lifetime	S2	17	30	
Bertoni	PE-Lifetime	S2	18	29	
Butterfield	PE-Lifetime	S2	21	31	
Butterfield	PE-Lifetime	S2	22	30	
McNally	PE-Lifetime	S2	14	30	
McNally	PE-Lifetime	S2	19	29	
McNally	PE-Lifetime	S2	20	29	28.3
Krause	PE-Movement	S1	1	20	
Krause	PE-Movement	S1	2	21	
Krause	PE-Movement	S1	3	23	
Krause	PE-Movement	S1	4	17	
Krause	PE-Movement	S1	5	16	
Krause	PE-Movement	S1	6	23	
Krause	PE-Movement	S1	7	25	
Krause	PE-Movement	S1	8	22	
Krause	PE-Movement	S1	9	23	
Krause	PE-Movement	S1	10	25	
Krause	PE-Movement	S1	11	26	
Krause	PE-Movement	S2	12	24	
Krause	PE-Movement	S2	13	21	
Krause	PE-Movement	S2	14	29	
Krause	PE-Movement	S2	15	18	
Krause	PE-Movement	S2	16	17	
Krause	PE-Movement	S2	17	18	
Krause	PE-Movement	S2	18	19	
Krause	PE-Movement	S2	19	20	
Krause	PE-Movement	S2	20	29	
Krause	PE-Movement	S2	21	25	
Krause	PE-Movement	S2	22	21	21.9
Bertoni	PE-Personal Fitness	S1	1	7	
Bertoni	PE-Personal Fitness	S1	4	11	
Butterfield	PE-Personal Fitness	S1	2	11	
Butterfield	PE-Personal Fitness	S1	3	15	
Bertoni	PE-Personal Fitness	S2	5	7	
Butterfield	PE-Personal Fitness	S2	6	8	
Butterfield	PE-Personal Fitness	S2	7	15	10.6
McNally	PE-Lifetime II	S1	1	26	

**Class Size Report
2013-2014**

Shrewsbury High School
Health and Physical Education

October 1, 2013

Last Name	Course Name	Term	Section Number	Class Size	Average Class Size
McNally	PE-Lifetime II	S1	3	20	
McNally	PE-Lifetime II	S1	4	23	
McNally	PE-Lifetime II	S1	6	26	
McNally	PE-Lifetime II	S1	7	23	
McNally	PE-Lifetime II	S1	8	29	
McNally	PE-Lifetime II	S1	9	30	
Toti	PE-Lifetime II	S1	2	22	
Toti	PE-Lifetime II	S1	5	27	
McNally	PE-Lifetime II	S2	10	19	
McNally	PE-Lifetime II	S2	11	15	
McNally	PE-Lifetime II	S2	13	26	
McNally	PE-Lifetime II	S2	14	27	
McNally	PE-Lifetime II	S2	15	28	
McNally	PE-Lifetime II	S2	16	27	
McNally	PE-Lifetime II	S2	18	28	
McNally	PE-Lifetime II	S2	19	24	
Toti	PE-Lifetime II	S2	12	25	
Toti	PE-Lifetime II	S2	17	18	24.4
Ferris	Health 9: Wellness	S1	1	30	
Ferris	Health 9: Wellness	S1	2	29	
Ferris	Health 9: Wellness	S1	3	28	
Hickey	Health 9: Wellness	S1	4	29	
Hickey	Health 9: Wellness	S1	5	30	
Hickey	Health 9: Wellness	S1	6	30	
Hickey	Health 9: Wellness	S1	15	16	
Ferris	Health 9: Wellness	S2	7	30	
Ferris	Health 9: Wellness	S2	8	28	
Ferris	Health 9: Wellness	S2	9	30	
Ferris	Health 9: Wellness	S2	10	29	
Hickey	Health 9: Wellness	S2	11	17	
Hickey	Health 9: Wellness	S2	12	30	
Hickey	Health 9: Wellness	S2	13	29	
Hickey	Health 9: Wellness	S2	14	27	27.5
Ferris	Health 10: Healthy	S1	1	27	
Ferris	Health 10: Healthy	S1	2	21	
Ferris	Health 10: Healthy	S1	3	15	
Ferris	Health 10: Healthy	S1	6	23	
Ferris	Health 10: Healthy	S1	7	24	
Ferris	Health 10: Healthy	S1	8	27	
Ferris	Health 10: Healthy	S1	9	19	
Morin	Health 10: Healthy	S1	13	27	
Morin	Health 10: Healthy	S1	14	27	
Morin	Health 10: Healthy	S1	17	16	
Ferris	Health 10: Healthy	S2	4	20	
Ferris	Health 10: Healthy	S2	5	21	

**Class Size Report
2013-2014**

Shrewsbury High School
Health and Physical Education

October 1, 2013

Last Name	Course Name	Term	Section Number	Class Size	Average Class Size
Ferris	Health 10: Healthy	S2	10	21	
Ferris	Health 10: Healthy	S2	11	26	
Ferris	Health 10: Healthy	S2	12	18	
Ferris	Health 10: Healthy	S2	19	25	
Morin	Health 10: Healthy	S2	15	28	
Morin	Health 10: Healthy	S2	16	28	22.9
Hickey	Health 11: Lifelong	S1	18	25	
Morin	Health 11: Lifelong	S1	10	25	
Morin	Health 11: Lifelong	S1	11	23	
Morin	Health 11: Lifelong	S1	12	20	
Morin	Health 11: Lifelong	S1	13	27	
Morin	Health 11: Lifelong	S1	14	27	
Morin	Health 11: Lifelong	S1	15	26	
Morin	Health 11: Lifelong	S1	16	27	
Hickey	Health 11: Lifelong	S2	17	20	
Morin	Health 11: Lifelong	S2	2	27	
Morin	Health 11: Lifelong	S2	3	27	
Morin	Health 11: Lifelong	S2	4	25	
Morin	Health 11: Lifelong	S2	5	23	
Morin	Health 11: Lifelong	S2	6	20	
Morin	Health 11: Lifelong	S2	7	27	
Morin	Health 11: Lifelong	S2	8	27	
Morin	Health 11: Lifelong	S2	9	25	24.8
Hickey	Adaptive Health	S1	1	7	
Hickey	Adaptive Health	S2	2	3	5.0

**Class Size Report
2013-2014**

Shrewsbury High School
Instructional Technology and Media Services

October 1, 2013

ITAMS					
	FTE	# of Sections	# of Students	Avg. Class Size	
Calabresi	1.0	10	183	18.3	
Korab	1.0	8	107	13.4	
Total	2.0	18	290	16	
Last Name	Course Name	Term	Section Number	Class Size	Average Class Size
Calabresi	Introduction to Computer Science	S1	1	11	
Calabresi	Introduction to Computer Science	S2	2	14	12.5
Calabresi	**Multimedia Application & Advanced	S1	1	16	
Calabresi	**Multimedia Application & Advanced	S1	2	17	
Calabresi	**Multimedia Application & Advanced	S2	3	19	
Calabresi	**Multimedia Application & Advanced	S2	4	17	17.3
Calabresi	Web Design	S1	1	24	
Calabresi	Web Design	S1	2	20	
Calabresi	Web Design	S2	3	23	
Calabresi	Web Design	S2	4	22	22.3
Korab	Introduction to TV Production	S1	1	15	
Korab	Introduction to TV Production	S1	2	14	
Korab	Introduction to TV Production	S1	3	13	
Korab	Introduction to TV Production	S2	5	13	
Korab	Introduction to TV Production	S2	6	13	
Korab	Introduction to TV Production	S2	4	12	13.3
Korab	TV Production II	FY 13-14	1	15	15.0
Korab	Advanced TV Production Honors	FY 13-14	1	12	12.0

**These classes are offered at combined levels.

**Class Size Report
2013-2014**

Shrewsbury High School
Math Department

October 1, 2013

Math	FTE	# of Sections	# of Students	Avg. Class Size
Blasioli	1.0	5	119	23.8
Busso	1.0	5	110	22.0
Cobb	1.0	5	120	24.0
Collins	1.0	5	131	26.2
Satterfield	1.0	5	125	25.0
Gardner	1.0	5	124	24.8
Johnson	0.4	2	51	25.5
Kuczinski	1.0	5	122	24.4
Lowery	1.0	5	112	22.4
McDonagh	1.0	5	97	19.4
Moisan	1.0	5	110	22.0
Mongiat	1.0	5	119	23.8
Prior	1.0	5	121	24.2
Schroen	0.4	2	43	21.5
Weir	1.0	5	118	23.6
Total	13.8	69	1622	23.5

Last Name	Course Name	Term	Section Number	Class Size	Average Class Size
McDonagh	Algebra & Geometry I	FY 13-14	1	9	
McDonagh	Algebra & Geometry I	FY 13-14	2	19	
McDonagh/Heald co-taught	Algebra & Geometry I	FY 13-14	1	12	
Mongiat	Algebra & Geometry I	FY 13-14	3	22	15.5
Blasioli	**Algebra & Geometry II & IIB	FY 13-14	6	21	
Blasioli	**Algebra & Geometry II & IIB	FY 13-14	9	23	
Blasioli/Murray ELE co-taught	**Algebra & Geometry II & IIB	FY 13-14	11	19	
Busso	**Algebra & Geometry II & IIB	FY 13-14	1	26	
Busso	**Algebra & Geometry II & IIB	FY 13-14	2	25	
Busso	**Algebra & Geometry II & IIB	FY 13-14	4	25	
Lowery	**Algebra & Geometry II & IIB	FY 13-14	10	20	
Mongiat	**Algebra & Geometry II & IIB	FY 13-14	3	24	
Mongiat	**Algebra & Geometry II & IIB	FY 13-14	5	16	
Satterfield	**Algebra & Geometry II & IIB	FY 13-14	8	20	
Weir	**Algebra & Geometry II & IIB	FY 13-14	7	18	21.5
Blasioli	Algebra & Geometry II Honors	FY 13-14	4	28	
Blasioli	Algebra & Geometry II Honors	FY 13-14	3	28	
Kuczinski	Algebra & Geometry II Honors	FY 13-14	2	27	
Kuczinski	Algebra & Geometry II Honors	FY 13-14	1	27	
Mongiat	Algebra & Geometry II Honors	FY 13-14	6	29	
Mongiat	Algebra & Geometry II Honors	FY 13-14	5	28	27.8
Busso	Research Methods & Alg/Geom II Honors	FY 13-14	1	19	19.0
Cobb	Advanced Math I Honors	FY 13-14	2	28	
McDonagh	Advanced Math I Honors	FY 13-14	3	28	
McDonagh	Advanced Math I Honors	FY 13-14	1	29	
Weir	Advanced Math I Honors	FY 13-14	4	28	
Weir	Advanced Math I Honors	FY 13-14	5	29	28.4
Collins	**Research Methods & Adv. Math I Honors	FY 13-14	1	30	30.0
Cobb	**Advanced Math I & IB	FY 13-14	10	19	
Collins	**Advanced Math I & IB	FY 13-14	9	20	

**Class Size Report
2013-2014**

Shrewsbury High School
Math Department

October 1, 2013

Last Name	Course Name	Term	Section Number	Class Size	Average Class Size
Gardner	**Advanced Math I & IB	FY 13-14	3	21	
Gardner	**Advanced Math I & IB	FY 13-14	8	23	
Kuczinski	**Advanced Math I & IB	FY 13-14	4	21	
Kuczinski	**Advanced Math I & IB	FY 13-14	5	23	
McDonagh	**Advanced Math I & IB	FY 13-14	11	18	
Moisan	**Advanced Math I & IB	FY 13-14	1	22	
Moisan	**Advanced Math I & IB	FY 13-14	7	21	
Weir	**Advanced Math I & IB	FY 13-14	2	20	
Weir	**Advanced Math I & IB	FY 13-14	6	23	21.0
Cobb	Pre-Calculus	FY 13-14	1	27	
Cobb	Pre-Calculus	FY 13-14	3	26	
Lowery	Pre-Calculus	FY 13-14	5	27	
Lowery	Pre-Calculus	FY 13-14	6	24	
Satterfield	Pre-Calculus	FY 13-14	2	28	
Satterfield	Pre-Calculus	FY 13-14	4	26	26.3
Gardner	Pre-Calculus Honors	FY 13-14	7	28	
Johnson	Pre-Calculus Honors	FY 13-14	1	26	
Johnson	Pre-Calculus Honors	FY 13-14	2	25	
Prior	Pre-Calculus Honors	FY 13-14	3	28	
Prior	Pre-Calculus Honors	FY 13-14	5	25	
Prior	Pre-Calculus Honors	FY 13-14	4	27	
Satterfield	Pre-Calculus Honors	FY 13-14	6	24	26.1
Satterfield	Pre-Calculus Honors	FY 13-14	6	24	
Collins	Advanced Quantitative Reasoning	FY 13-14	1	28	
Collins	Advanced Quantitative Reasoning	FY 13-14	3	28	
Moisan	Advanced Quantitative Reasoning	FY 13-14	2	24	
Moisan	Advanced Quantitative Reasoning	FY 13-14	4	28	27.0
Prior	Functions & Trigonometry	FY 13-14	2	23	
Prior	Functions & Trigonometry	FY 13-14	1	21	
Kuczinski	Functions & Trigonometry	FY 13-14	3	24	22.7
Gardner	Calculus Honors	FY 13-14	1	27	
Gardner	Calculus Honors	FY 13-14	3	25	
Schroen	Calculus Honors	FY 13-14	2	19	
Schroen	Calculus Honors	FY 13-14	4	24	23.8
Lowery	AP Calculus AB	FY 13-14	1	19	
Lowery	AP Calculus AB	FY 13-14	2	22	20.5
Collins	AP Calculus BC	FY 13-14	1	25	
Prior	AP Calculus BC	FY 13-14	2	24	24.5
Cobb	AP Statistics	FY 13-14	1	20	
Busso	AP Statistics	FY 13-14	2	15	17.5
Moisan	Accounting	FY 13-14	1	15	15.0
**These classes are offered at combined levels.					

**Class Size Report
2013-2014**

Shrewsbury High School
Music Department

October 1, 2013

Music	FTE	# of Sections	# of Students	Avg. Class Size	
Lapomardo	1.0	6	209	34.8	
Liporto	0.6	4	135	33.8	
Narcisi	0.3	2	37	18.5	
Webb	0.2	2	37	18.5	
Total	2.1	14	418	29.9	
Last Name	Course Name	Term	Section Number	Class Size	Average Class Size
Narcisi	Acapella Choir Honors	FY 13-14	1	21	21
Narcisi	Theatre Arts I	S1	1	16	
Lapomardo	Theatre Arts I	S2	2	17	16.5
Lapomardo	Orchestra & Orchestra Honors	FY 13-14	1	63	63
Lapomardo	Theatrical Design	S1	1	15	15
Lapomardo	Freshman Choir	FY 13-14	1	39	39
Lapomardo	Mixed Choir	FY 13-14	1	56	56
Lapomardo	Women's Choir Honors	FY 13-14	1	19	19
Liporto	Music Technology	S1	1	16	
Liporto	Music Technology	S2	2	15	15.5
Liporto	Jazz Band/Wind Ensemble/Concert Band Honors	FY 13-14	1	45	45
Liporto	Concert Band	FY 13-14	1	59	59
Webb	Movement for Theatre	S2	1	20	20
Webb	Directing/Playwriting I	S1	1	17	17

Science					
	FTE	# of Sections	# of Students	Avg. Class Size	
Carter	1.0	5	135	27.0	
Chico	1.0	5	132	26.4	
Constantine	1.0	5	111	22.2	
Duggan	1.0	6	149	24.8	
Heaney	0.8	4	117	29.3	
Hruskoci	0.4	4	107	26.8	
Lambert-Peloquin	1.0	5	81	16.2	
Leahy	1.0	6	143	23.8	
Lowery	1.0	5	123	24.6	
Lumley-Chan	0.6	3	84	28.0	
Moynihan	1.0	5	117	23.4	
O'Connor	1.0	7	180	25.7	
Roland	1.0	5	95	19.0	
Schroen	0.6	3	82	27.3	
Wilson	1.0	5	109	21.8	
Total	13.4	73	1765	24.2	
Last Name	Course Name	Term	Section Number	Class Size	Average Class Size
Roland	Lab Introductory Physics	FY 13-14	1	12	
Roland	Lab Introductory Physics	FY 13-14	2	17	14.5
Heaney	Introductory Physics	FY 13-14	5	28	
Heaney	Introductory Physics	FY 13-14	8	28	
Lumley-Chan	Introductory Physics	FY 13-14	1	29	
Lumley-Chan	Introductory Physics	FY 13-14	3	28	
Lumley-Chan	Introductory Physics	FY 13-14	2	27	
Schroen	Introductory Physics	FY 13-14	4	27	
Schroen	Introductory Physics	FY 13-14	6	28	
Schroen	Introductory Physics	FY 13-14	7	27	27.8
Chico	Introductory Physics Honors	FY 13-14	3	30	
Heaney	Introductory Physics Honors	FY 13-14	1	31	
Heaney	Introductory Physics Honors	FY 13-14	2	30	30.3
Lambert-Peloquin	Lab Biology	FY 13-14	1	7	
Lambert-Peloquin	Lab Biology	FY 13-14	1	13	
Lambert-Peloquin	Lab Biology	FY 13-14	2	12	10.7
Chico	Biology	FY 13-14	4	22	
Chico	Biology	FY 13-14	3	22	
Lambert-Peloquin	Biology	FY 13-14	5	23	
Lambert-Peloquin	Biology	FY 13-14	6	26	
Wilson	Biology	FY 13-14	1	23	
Wilson	Biology	FY 13-14	2	23	23.2
Carter	Biology Honors	FY 13-14	4	28	
Duggan	Biology Honors	FY 13-14	7	29	
Duggan	Biology Honors	FY 13-14	6	27	
Duggan	Biology Honors	FY 13-14	5	27	
Lambert-Peloquin	Biology Honors	FY 13-14	3	28	
O'Connor	Biology Honors	FY 13-14	1	27	
O'Connor	Biology Honors	FY 13-14	2	27	27.6
Constantine/Gonzales	Lab Chemistry	FY 13-14	1	12	
Moynihan	Lab Chemistry	FY 13-14	1	17	14.5
Leahy	Chemistry	FY 13-14	2	26	
Leahy	Chemistry	FY 13-14	3	25	
Leahy	Chemistry	FY 13-14	1	26	
Lowery	Chemistry	FY 13-14	4	26	
Lowery	Chemistry	FY 13-14	5	26	

Last Name	Course Name	Term	Section Number	Class Size	Average Class Size
Moynihan	Chemistry	FY 13-14	7	25	
Moynihan	Chemistry	FY 13-14	6	26	25.7
Constantine	Chemistry Honors	FY 13-14	4	25	
Constantine	Chemistry Honors	FY 13-14	7	24	
Constantine	Chemistry Honors	FY 13-14	6	24	
Leahy	Chemistry Honors	FY 13-14	1	24	
Lowery	Chemistry Honors	FY 13-14	3	25	
Moynihan	Chemistry Honors	FY 13-14	2	25	
Moynihan	Chemistry Honors	FY 13-14	8	25	
		FY 13-14	5	24	24.5
Constantine	Research Methods & Chemistry Honors	FY 13-14	1	26	26.0
Carter	Research Methods & Biology Honors	FY 13-14	1	23	23.0
Carter	Human Anatomy & Physiology Honors	FY 13-14	3	28	
Carter	Human Anatomy & Physiology Honors	FY 13-14	2	28	
Carter	Human Anatomy & Physiology Honors	FY 13-14	1	28	28.0
Roland	Physics	FY 13-14	2	24	
Roland	Physics	FY 13-14	1	25	24.5
Chico	Physics Honors	FY 13-14	2	29	
Chico	Physics Honors	FY 13-14	1	29	29.0
Leahy	Earth Systems Science	S1	1	21	
Leahy	Earth Systems Science	S2	2	21	21.0
Wilson	Environmental Science	FY 13-14	2	22	
Wilson	Environmental Science	FY 13-14	1	27	24.5
Wilson	AP Environmental Science	FY 13-14	1	14	14.0
Duggan	AP Biology	FY 13-14	2	14	
O'Connor	AP Biology	FY 13-14	1	23	18.5
Roland	AP Physics	FY 13-14	1	17	17.0
Lowery	AP Chemistry	FY 13-14	1	21	21.0
Duggan	*Bioethics & Bioethics Honors	S1	2	27	
O'Connor	*Bioethics & Bioethics Honors	S1	3	25	
O'Connor	*Bioethics & Bioethics Honors	S1	1	25	
Duggan	*Bioethics & Bioethics Honors	S2	2	25	
O'Connor	*Bioethics & Bioethics Honors	S2	3	27	
O'Connor	*Bioethics & Bioethics Honors	S2	4	26	25.8
Hruskoci	*Astronomy & Astronomy Honors	S1	1	26	
Hruskoci	*Astronomy & Astronomy Honors	S1	2	27	
Hruskoci	*Astronomy & Astronomy Honors	S2	3	27	
Hruskoci	*Astronomy & Astronomy Honors	S2	4	27	26.8

**These classes are offered at combined levels.

**Class Size Report
2013-2014**

Shrewsbury High School
Social Sciences Department

October 1, 2013

Social Sciences					
	FTE	# of Sections	# of Students	Avg. Class Size	
Aloisi	1.0	5	121	24.2	
Brown	1.0	6	163	27.2	
Burke	1.0	5	113	22.6	
Scheer	1.0	5	129	25.8	
Charest	1.0	6	162	27.0	
DiFrancesca	0.4	2	60	30.0	
Grady	1.0	7	185	26.4	
Gray	1.0	7	207	29.6	
Hertel-Therrien	1.0	5	123	24.6	
O'Leary	1.0	6	142	23.7	
Mulryan	1.0	5	121	24.2	
Smith	1.0	5	130	26.0	
Rigberg	1.0	5	125	25.0	
Total	12.4	69	1781	25.8	
Last Name	Course Name	Term	Section Number	Class Size	Average Class Size
Brown	World Civilization	FY 13-14	5	28	
Brown	World Civilization	FY 13-14	14	25	
Charest	World Civilization	FY 13-14	10	27	
Charest	World Civilization	FY 13-14	7	28	
Hertel-Therrien	World Civilization	FY 13-14	11	26	
O'Leary	World Civilization	FY 13-14	1	28	
O'Leary	World Civilization	FY 13-14	4	28	
O'Leary	World Civilization	FY 13-14	6	28	
Rigberg	World Civilization	FY 13-14	13	27	
Rigberg	World Civilization	FY 13-14	9	27	
Rigberg	World Civilization	FY 13-14	2	28	
Scheer	World Civilization	FY 13-14	3	28	
Scheer	World Civilization	FY 13-14	12	29	
Smith	World Civilization	FY 13-14	15	27	
Smith	World Civilization	FY 13-14	8	28	27.5
Burke	US History I	FY 13-14	5	24	
Burke	US History I	FY 13-14	6	20	
Hertel-Therrien	US History I	FY 13-14	2	26	
Hertel-Therrien	US History I	FY 13-14	8	23	
Mulryan	US History I	FY 13-14	3	23	
Mulryan	US History I	FY 13-14	4	20	
Scheer	US History I	FY 13-14	7	24	
Scheer	US History I	FY 13-14	1	24	23.0
Burke	US History I Honors	FY 13-14	7	21	
Burke	US History I Honors	FY 13-14	8	25	
Charest	US History I Honors	FY 13-14	1	22	
Charest	US History I Honors	FY 13-14	2	26	
Hertel-Therrien	US History I Honors	FY 13-14	3	26	
Hertel-Therrien	US History I Honors	FY 13-14	5	22	
Mulryan	US History I Honors	FY 13-14	4	24	
Mulryan	US History I Honors	FY 13-14	9	24	
Scheer	US History I Honors	FY 13-14	6	24	23.8
Aloisi	US History II	FY 13-14	4	20	
Burke	US History II	FY 13-14	1	23	
Grady	US History II	FY 13-14	5	21	
Rigberg	US History II	FY 13-14	2	18	

**Class Size Report
2013-2014**

Shrewsbury High School
Social Sciences Department

October 1, 2013

Last Name	Course Name	Term	Section Number	Class Size	Average Class Size
Rigberg	US History II	FY 13-14	3	25	21.4
Aloisi	US History II Honors	FY 13-14	6	28	
Aloisi	US History II Honors	FY 13-14	3	27	
Grady	US History II Honors	FY 13-14	1	21	
Grady	US History II Honors	FY 13-14	2	25	
Smith	US History II Honors	FY 13-14	5	24	
Smith	US History II Honors	FY 13-14	4	26	25.2
Aloisi	*US History II: American Studies & Honors	FY 13-14	1	22	
Aloisi	*US History II: American Studies & Honors	FY 13-14	2	24	
Brown	*US History II: American Studies & Honors	FY 13-14	3	25	
Brown	*US History II: American Studies & Honors	FY 13-14	4	26	24.3
DiFrancesca	AP US History	FY 13-14	2	30	
DiFrancesca	AP US History	FY 13-14	1	30	30.0
Charest	*Economics & Honors	S1	1	29	
Charest	*Economics & Honors	S2	2	30	30.0
O'Leary	*Global Studies & Honors	S1	1	24	24.0
Brown	*America and the World Today & Honors	S1	1	29	
Brown	*America and the World Today & Honors	S2	2	30	29.5
Gray	*Psychology & Psychology Honors	S1	1	30	
Gray	*Psychology & Psychology Honors	S1	2	30	
Gray	*Psychology & Psychology Honors	S2	3	30	
Gray	*Psychology & Psychology Honors	S2	4	30	30.0
Grady	*Sociology & Sociology Honors	S1	1	29	
Grady	*Sociology & Sociology Honors	S1	2	29	
Grady	*Sociology & Sociology Honors	S2	3	30	
Grady	*Sociology & Sociology Honors	S2	4	30	29.5
O'Leary	*World Religions & World Religions Honors	S2	1	23	23.0
O'Leary	Asian & African Studies Honors	FY 13-14	1	11	11.0
Smith	Modern European History Honors	FY 13-14	1	25	25.0
Gray	AP Psychology	FY 13-14	3	29	
Gray	AP Psychology	FY 13-14	1	30	
Gray	AP Psychology	FY 13-14	2	28	29.0
Mulryan	AP Human Geography	FY 13-14	1	30	30.0

**These classes are offered at combined levels.

The information for the Special Education Department is presented in a different format from the other departments. Courses taught by each individual teacher are provided along with the total number of students for whom each teacher has liaison responsibility (write IEP, conduct team meeting, etc)

Teacher	Title	# of Students	FTE	Assignment
Bedrosian	Liaison	6	1.0	Vocational Explorations Life Skills Math Life Skills History Life Skills Science Life Skills English World of Work
Heald	Liaison	22	1.0	Learning Skills A/G I Co-Taught Test Learning Skills Learning Skills Learning Skills
Derosier	Liaison	6	1.0	Vocational Explorations Life Skills Math Life Skills History Life Skills Science Life Skills English World of Work
Gonzales	Liaison	20	1.0	Learning Skills Learning Skills Learning Skills Lab Chem Co-Taught Lab Bio Co-Taught Learning Skills In School Work Experience
Hens	Liaison	21	1.0	Learning Skills Learning Skills Biology – Co-Taught Learning Skills Learning Skills Learning Skills
McSweeney	Liaison	13	1.0	TEST Admin Learning Skills Learning Skills TEST Admin

Class Size Report 2013-14

Special Education Department

McSweeney	Liaison	13	1.0	TEST Admin Learning Skills Learning Skills TEST Admin
Neiman	Psychologist	15	1.0	Academic Support (10) Counseling-Individual and Groups -as needed TEST
O'Connor	Liaison	19	1.0	Learning Skills Learning Skills Learning Skills Technology Explorations MOVE (vocational) MOVE (vocational)
Quinn	Speech	58	1.0	Speech/Language Services and Groups as determined by IEPs
Foster	Liaison	21	1.0	Essential History 9-10 Essential History 11-12 Learning Skills Learning Skills Learning Skills Learning Skills
Shaughnessy	Liaison	23	1.0	Learning Skills Learning Skills Essential English Learning Skills Test Learning Skills
Sherman	Liaison	22	1.0	Essential Math 11-12 Essential Math 9-10 Learning Skills Learning Skills Learning Skills SSD Administration
Simler	Liaison	11	.5	Learning Skills/Reading Essential English

**Class Size Report
2013-2014**

Shrewsbury High School
Special Programs

October 1, 2013

Special Programs				
	FTE	# of Sections	# of Students	Avg. Class Size
Arnold (VHS)	0.2	N/A	N/A	N/A
Vigliatura (VHS)	0.2	N/A	37	N/A
Last Name	Course Name	Term	Section Number	Class Size
Vigliatura	VHS AP Art History	FY 13-14	1	1
Vigliatura	VHS AP Economics: Micro and Macro	FY 13-14	9	3
Vigliatura	VHS AP Govern & Politics: U.S.	FY 13-14	5	9
Vigliatura	VHS AP Economics Micro & Macro	S1	1	1
Vigliatura	VHS Criminology Honors	S1	12	2
Vigliatura	VHS Genes & Diseases Honors	S1	1	1
Vigliatura	VHS International Business	S1	5	3
Vigliatura	VHS Investing: Stock Market	S1	1	1
Vigliatura	VHS Kindergarten Apprentice Teacher	S1	5	2
Vigliatura	VHS Marketing & the Internet	S1	1	1
Vigliatura	VHS Pre-Vet Medicine Honors	S1	1	1
Vigliatura	VHS 101 Ways to Write a Short Story	S2	1	1
Vigliatura	VHS AP Economics Micro & Macro	S2	2	1
Vigliatura	VHS Biotechnology	S2	1	1
Vigliatura	VHS Computational Sci. & Engineer. Hon	S2	1	1
Vigliatura	VHS Criminology Honors	S2	1	2
Vigliatura	VHS Folklore and Literature	S2	1	1
Vigliatura	VHS Kindergarten Apprentice Teacher	S2	1	2
Vigliatura	VHS Psychology of a Crime	S2	1	1
Vigliatura	VHS Psychology of a Crime Honors	S2	1	1
Vigliatura	VHS Sports & American Society	S2	2	1
				37

**Class Size Report
2013-2014**

Shrewsbury High School
Technology Education

October 1, 2013

Technology					
	FTE	# of Sections	# of Students	Avg. Class Size	
Heaney	0.2	1	25	25.0	
Wood	1.0	7	148	21.1	
Total	1.2	8	173	21.6	
Last Name	Course Name	Term	Section Number	Class Size	Average Class Size
Heaney	Engineering the Future	FY 13-14	3	25	25.0
Wood	Explore Technology Semester	S1	2	19	
Wood	Explore Technology Semester	S1	1	19	19.0
Wood	Intro to Engineering Design	FY 13-14	2	22	
Wood	Intro to Engineering Design	FY 13-14	1	23	22.5
Wood	Principles of Engineering Honors	FY 13-14	1	23	23.0
Wood	Robotics/Electronics	S2	2	21	
Wood	Robotics/Electronics	S2	1	21	21.0

**Class Size Report
2013-2014**

Shrewsbury High School
Visual Arts Department

October 1, 2013

Visual Arts					
	FTE	# of Sections	# of Students	Avg. Class Size	
Butler	1.0	10	161	16.1	
Cobb	1.0	9	177	19.7	
Fox	1.0	9	196	21.8	
LeBlanc	0.4	3	74	24.7	
Total	3.4	31	608	19.6	
Last Name	Course Name	Term	Section Number	Class Size	Average Class Size
Cobb	*AP Studio Art & Studio III Honors	FY 12-13	1	14	14.0
Cobb	Art Intro	S1	5	19	
Cobb	Art Intro	S1	6	24	
LeBlanc	Art Intro	S1	1	16	
LeBlanc	Art Intro	S1	2	17	
Cobb	Art Intro	S2	7	20	
Cobb	Art Intro	S2	8	21	
Cobb	Art Intro	S2	9	18	
LeBlanc	Art Intro	S2	4	24	
LeBlanc	Art Intro	S2	3	17	19.6
Butler	Ceramics	S1	1	17	
Butler	Ceramics	S1	3	18	
Butler	Ceramics	S1	2	18	
Butler	Ceramics	S2	4	18	
Butler	Ceramics	S2	5	18	
Butler	Ceramics	S2	6	16	
Butler	Ceramics	S2	7	18	17.6
Butler	Ceramics II and Sculpture	S1	1	12	
Butler	Ceramics II and Sculpture	S2	2	13	12.5
Butler	Ceramics III and Sculpture	S1	1	13	13.0
Fox	Creative Sketchbooks	S1	1	23	
Fox	Creative Sketchbooks	S1	2	23	23.0
Fox	Digital Imaging	S1	3	21	
Fox	Digital Imaging	S1	4	22	
Fox	Digital Imaging	S2	5	18	
Fox	Digital Imaging	S2	6	21	
Cobb	Digital Imaging	S1	1	19	
Cobb	Digital Imaging	S1	2	22	20.5
Cobb	Digital Imaging II	S2	1	20	20.0
Fox	Mixed Media	S2	2	22	
Fox	Mixed Media	S2	1	25	23.5
Fox	Studio I	FY 13-14	1	21	21.0



**SHREWSBURY PUBLIC SCHOOLS
SCHOOL COMMITTEE**

**ITEM NO: IV. Time Scheduled Appointment
E. Fiscal Year 2014 Staffing: Report**

MEETING DATE: 10/23/13

SPECIFIC STATEMENT OR QUESTION:

Will the School Committee hear a report on staffing levels for Fiscal Year 2014?

BACKGROUND INFORMATION:

1. The enclosed report provides information on actual staffing levels compared with projected levels from the original FY14 budget documents.
2. Ms. Malone will provide a summary of the report and answer questions.

ACTION RECOMMENDED:

That the School Committee accept the report and take whatever steps it deems necessary in the interests of the Shrewsbury Public Schools.

STAFF AVAILABLE FOR PRESENTATION:

Ms. Barbara Malone, Director of Human Resources



Shrewsbury Public Schools

Barbara A. Malone, Director of HR

FY 14 STAFFING LEVELS Effective October 1, 2013

Background

For the last several years the administration has created a staffing chart to indicate the utilization of staff by position, department, and school level. This staffing chart is created while budgets are being developed in the spring, and then updated on October 1 of the fiscal year. Included at the end of this packet is the information shared in previous years with an update for October 1, 2013 (FY 14). Before looking at this budget information I would also like to present the information and charts that were provided for the first time last year.

Total FTE Positions Trend

The following chart represents the movement in positions from FY 2010 to FY 2014. It shows the year over year trend of total FTE positions funded to support the schools. It is important to note that while this chart shows only the most recent five years, FY 2008 was the School Department's "high water" mark of 734.16 FTE positions. It is also important to note, and will be demonstrated in successive charts, that the positions that have increased from FY 13 to FY 14 are mandated positions, positions to increase capacity to address mental health needs of our students, positions funded by kindergarten tuition, and door monitors/security in the "post-Sandy Hook era", with only minor adjustments to FTE allocations for classroom teachers.

Total Positions

Chart 1

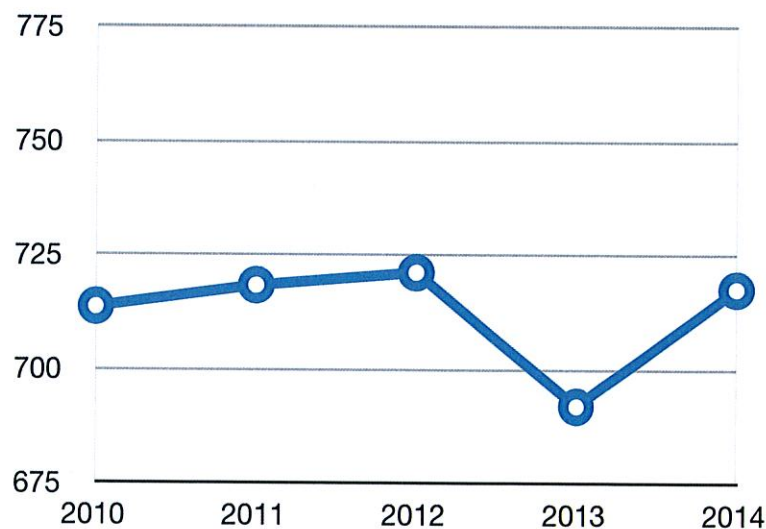

Academic Teacher Compared to Instructional Support Trend

This next chart shows changes in the allocation of FTE positions available for the various functions. Instructional Classroom positions include the K-4 Classroom, Academic Subjects Grades 5-8, English and Language Arts, Mathematics, Science, Social Studies, and Foreign Language Teachers at the High School and Middle Schools, as well as English as a Second Language educators.

Instructional Specialists include Family and Consumer Science, Technology Education, Music, Art, Physical Education, and Health Education.

Instructional Support includes Special Education, Guidance, Curriculum Coach, Reading and Media Specialist, School Psychologist, Nurse, and Speech, Language, and Occupational Therapist positions.

Classified Staff refers to Tutors, Instructional Aides, Secretaries, Media Aides, and various Paraprofessional positions, including those that exist due to mandated service requirements.

Administration includes the Superintendent, Assistant Superintendent, Directors, Principals, Assistant Principals, and Department Directors.

What is interesting to note is that while most FTE totals have generally declined or held steady, from FY 2013 to FY 2014 Classified Staff has increased, mainly due to mandated service requirements.

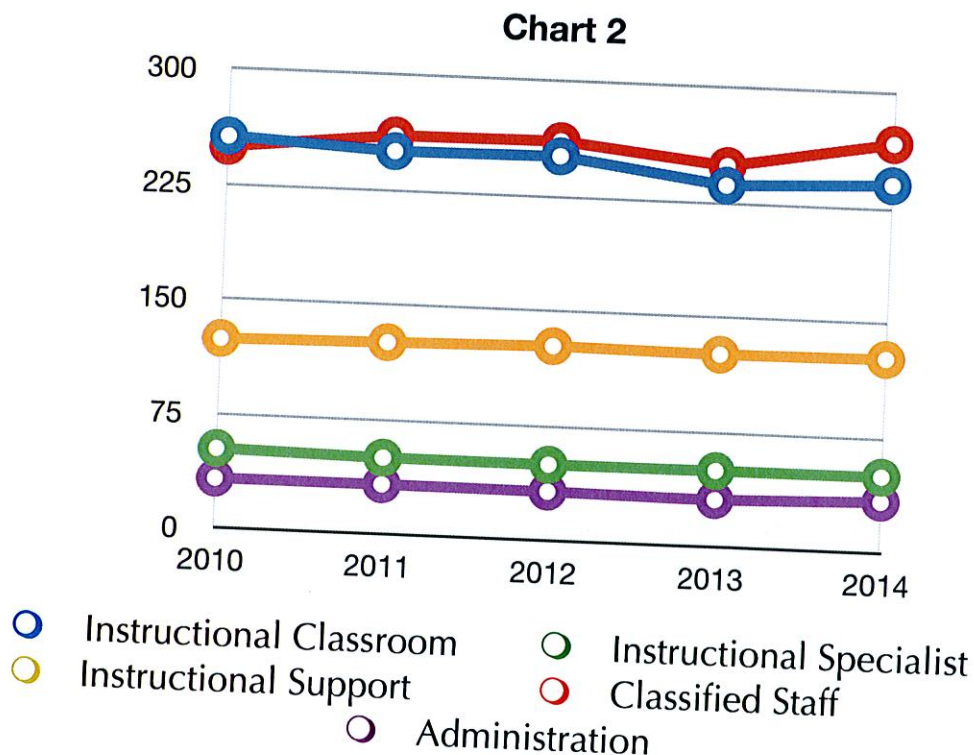

Another way to look at this information is to show the **FTE positions lost or gained each year**. Please note that the shift in Administration totals is due to bringing the Beal Principal position out of hiatus, bringing a portion of the Foreign Language Director position out of hiatus, and moving the Special Education Out of District Coordinator position out of Unit A (teachers) and into the Administration totals. As you can see the five year trend is a loss of instructional classroom positions, an increase in Instructional Support positions, mainly due to mandated service needs, and a bringing back of classified staff positions, again mainly due to mandated service needs.

Table 1

Position Type	FY2010	FY2011	FY2012	FY2013	FY2014	Net Change
Instructional Classroom	-2.60	-5.90	+1.00	-14.90	+4.00	-18.40
Instructional Specialist	-1.30	-2.00	-0.20	+0.10	0.00	-3.40
Instructional Support	+6.30	+1.54	+1.80	-1.30	+90	+9.24
Classified Staff	-18.80	+11.10	+0.65	-11.90	+18.07	-0.88
Administration	-1.00	0.00	-0.40	-1.30	+2.70	0.00
Totals	-17.40	+4.74	+2.85	-29.30	+25.67	-13.44

Finally, the following table demonstrates the changes in FTE positions from last year to this year, in the same highlighted categories. Last Spring the "carry forward" budget allowed for 720.28 positions and we are reporting 717.52 positions as of October 1, 2013. This difference is largely accounted for by unfilled Special Education paraprofessional positions, and recruiting efforts are ongoing to meet student needs. The School Department is a dynamic, changing environment as students move into and out of the district and allocations flex to meet these changing student needs.

Table 2

Position Type	FY2013	FY2014	Net Change
Instructional Classroom	236.20	240.20	+4.00
Instructional Specialist	49.80	49.80	0.00
Instructional Support	125.90	126.80	+90
Classified Staff	249.15	267.22	+18.07
Administration	30.80	33.50	+2.70
Totals	691.85	717.52	+25.67

Enrollment Trend

The following chart shows the enrollment figures over the past five years. The net increase over this period shows an increasing enrollment, while, as we've seen, the number of instructional teachers has declined, leading to the current problem with class sizes. The declining staffing resources, coupled with the increased enrollment, has resulted in insufficient resources to meet student needs. Although we are innovating and collaborating to try and cope with increased demands, we continue to be concerned that the quality of the education provided to Shrewsbury students is deteriorating.

Chart 3

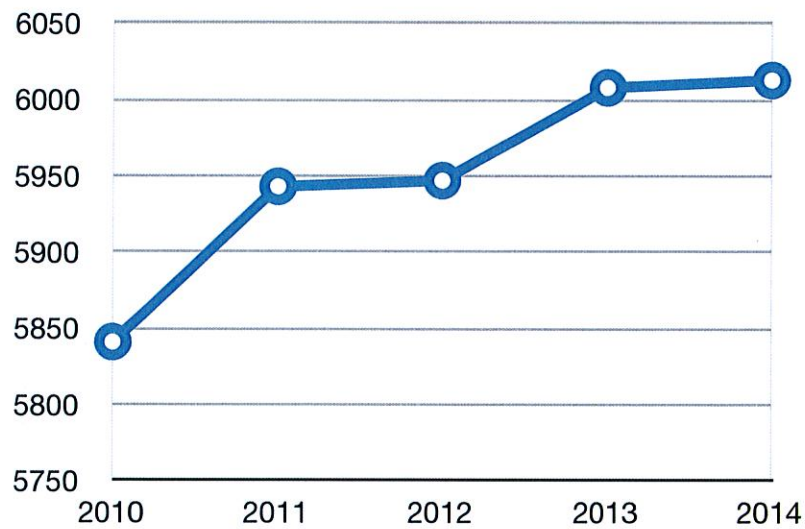

Detailed FTE Position Information

For the last several years the administration has created a staffing chart to indicate the utilization of staff by position, department, and school level. This staffing chart is created while budgets are being developed in the spring. Included with this packet are staffing level charts for FY 14, and FY 13, with summary information below on FY 12, FY 11 and FY 10.

There are two charts for FY 14. One chart is based on the projected staffing for FY14. The second chart reflects the actual staffing that is in effect as of October 1, 2013. These charts represent the full time equivalency (FTE) for the positions in the district.

A summary of the information for the past five years is:

FY 14	717.52 positions (reflects actual staffing levels as of October 1, 2013)
FY 14	720.28 positions (reflects projected staffing levels in March of 2013)
FY 13	691.85 positions
FY 12	721.15 positions
FY 11	718.30 positions
FY 10	713.56 positions

FY 14 Staffing Overview

The information during budget development projected a total FTE of 720.28 positions. As of October 1, 2013 the total FTE count is 717.52. Each school year there are fluctuations in staffing needs, especially in the areas of special education and English language learners. The increase in positions from FY13 to FY14 is almost entirely accounted for by mandated special education needs, hiring of door monitors for security reasons, bringing back the Beal Principal position from hiatus, bringing back the Foreign Language Director position from hiatus, and positions to meet enrollment needs in kindergarten and foreign language.

Headcount versus FTE

The 717.52 positions reflect an actual headcount of 761 individuals. The difference in FTE versus headcount reflects employees who work less than a full-time schedule. For example, two aides who are each working 15 hours per week reflect 2 individuals in the headcount number, but only reflect 1 FTE as they are filling one position.

The staffing numbers reflected in the charts do not include employees working in the Food Service program or the employees working in the Extended School Care program, or Crossing Guards.

FY 2014 October 1, 2013

Shrewsbury Public Schools		Staffing Levels Oct. 1, 2013; presented to SC on October 23, 2013						
Position	Elem.	Gr.5/6	Gr.7/8	H.S.	PreK	PreK-8	PreK-12	Total
Administration								
Superintendent							1.00	1.00
Asst. Superintendent							1.00	1.00
Dir. Business Services							1.00	1.00
Dir. Special Education							1.00	1.00
Out of District Coordinator							1.00	1.00
Dir. Of Human Resource							1.00	1.00
Principals	5.00	1.00	1.00	1.00				8.00
Asst. Principals	1.00	2.00	2.00	3.00				8.00
Director of Technology							1.00	1.00
Assistant Director Special Ed.								0.00
Department Directors		0.60	0.60	3.80	1.00		3.50	9.50
Athletic Director				1.00				1.00
Subtotal	6.00	3.60	3.60	8.80	1.00	0.00	10.50	33.50
Instructional: Classroom								
K-4 Classroom	92.50							92.50
Academic Subjects (5-8)		34.60	32.00					66.60
English/Language Arts				13.40				13.40
Mathematics				14.40				14.40
Science				14.00				14.00
Social Studies				12.40				12.40
Foreign Language		2.10	7.90	9.70				19.70
ESL	4.00	1.00	1.00	1.20				7.20
Subtotal	96.50	37.70	40.90	65.10	0.00	0.00	0.00	240.20
Instructional: Specialist								
Fam & Con Science		1.00		2.00	0.80			3.80
Technology Education		0.50	0.50	3.00				4.00
Music	3.40	2.00	2.80	2.40				10.60
Art	3.70	1.00	1.00	3.40				9.10
Physical Education	3.00	2.00	2.00	6.00				13.00
Instructional Technology / VHS				0.20				0.20
Health Education	1.80	1.80	2.00	2.70				8.30
Jobs for Bay State Graduates								0.00
TV Studio				0.80				0.80
Subtotal	11.90	8.30	8.30	20.50	0.80	0.00	0.00	49.80
Instructional: Support								
Special Education	21.00	10.90	9.40	12.50	10.00		2.00	65.80
Guidance		1.00		6.60				7.60
Curriculum Coaches/Coord.	3.00	2.00	2.00					7.00
Title I/Reading	1.00	1.00						2.00
Media Specialists	1.00	0.50	0.50	1.00				3.00
Adj. Coun/Sch. Psych.	6.60	3.00	2.00	2.00	1.00			14.60
Speech/Language & OT	7.80	1.40	2.00	1.00	3.60		1.00	16.80
Nurse	5.00	1.00	1.00	2.00	1.00			10.00
Subtotal	45.40	20.80	16.90	25.10	15.60	0.00	3.00	126.80
Classified Staff								
Tutors/Technology Support	7.69	0.65	2.00	2.60			7.00	19.94
Instructional Aides	35.38			1.00	1.50			37.88
SPED/ABA/COTA/Speech Aide	66.09	26.03	18.08	28.40	25.18		2.77	166.55
Media Aides/Paraprofessionals	5.50	1.40	0.60	1.00				8.50
Secretary	6.50	2.00	2.00	7.00	1.00		11.85	30.35
Door Monitory (Security)	2.00	0.50	0.50					3.00
Courier							1.00	1.00
Subtotal	123.16	30.58	23.18	40.00	27.68	0.00	22.62	267.22
Totals	282.96	100.98	92.88	159.50	45.08	0.00	36.12	717.52

Shrewsbury Public Schools		Staffing Levels FY'14 Projected; Spring 2013							
Position	Elem.	Gr.5/6	Gr.7/8	H.S.	PreK	PreK-8	PreK-12	Total	
Administration									
Superintendent							1.00	1.00	
Asst. Superintendent							1.00	1.00	
Dir. Business Services							1.00	1.00	
Dir. Special Education							1.00	1.00	
Out of District Coordinator							1.00	1.00	
Dir. Of Human Resource							1.00	1.00	
Principals	5.00	1.00	1.00	1.00				8.00	
Asst. Principals	1.00	2.00	2.00	3.00				8.00	
Director of Technology							1.00	1.00	
Assistant Director Special Ed.								0.00	
Department Directors		0.60	0.60	3.80	1.00		3.50	9.50	
Athletic Director							1.00	1.00	
Subtotal	6.00	3.60	3.60	7.80	1.00	0.00	11.50	33.50	
Instructional: Classroom									
K-4 Classroom	92.00							92.00	
Academic Subjects (5-8)		34.00	32.00					66.00	
English/Language Arts				13.40				13.40	
Mathematics				13.80				13.80	
Science				13.40				13.40	
Social Studies				12.40				12.40	
Foreign Language		2.80	6.10	10.60				19.50	
ESL	4.00	1.00	1.00	1.20				7.20	
Subtotal	96.00	37.80	39.10	64.80	0.00	0.00	0.00	237.70	
Instructional: Specialist									
Fam & Con Science				3.00	0.80			3.80	
Technology Education			1.00	1.20				2.20	
Music	3.80	2.40	2.20	2.10				10.50	
Art	3.70	1.00	1.00	3.40				9.10	
Physical Education	4.00	2.00	2.00	6.00			0.60	14.60	
Instructional Technology / VHS		1.00		1.20				2.20	
Health Education	1.50	1.50	1.00	2.60				6.60	
Jobs for Bay State Graduates								0.00	
TV Studio				0.80				0.80	
Subtotal	13.00	7.90	7.20	20.30	0.80	0.00	0.60	49.80	
Instructional: Support									
Special Education	22.00	11.40	9.40	10.50	10.00		3.00	66.30	
Guidance			1.00	6.60				7.60	
Curriculum Coaches/Coord.	3.00	2.00	2.00					7.00	
Title I/Reading	1.00	1.00						2.00	
Media Specialists	1.00	0.50	0.50	1.00				3.00	
Adj. Coun/Sch. Psych.	6.60	3.00	2.00	2.00	1.00			14.60	
Speech/Language & OT							16.80	16.80	
Nurse	5.00	1.00	1.00	2.00	1.00			10.00	
Subtotal	38.60	18.90	15.90	22.10	12.00	0.00	19.80	127.30	
Classified Staff									
Tutors/Technology Support	9.90	0.80	2.60	2.00			7.00	22.30	
Instructional Aides	33.50			1.00	5.50			40.00	
SPED/ABA/COTA/Speech Aide	62.00	24.03	17.00	27.40	24.80		11.80	167.03	
Media Aides/Paraprofessionals	5.50	1.00	1.00	1.00				8.50	
Secretary	6.50	2.00	2.00	7.00	1.00		11.85	30.35	
Door Monitory (Security)	2.00	0.40	0.40					2.80	
Courier							1.00	1.00	
Subtotal	119.40	28.23	23.00	38.40	31.30	0.00	31.65	271.98	
Totals	273.00	96.43	88.80	153.40	45.10	0.00	63.55	720.28	

FY 2013 October 1, 2012

Shrewsbury Public Schools									
Staffing Levels FY13 As of October 1, 2012									
Position	Elem.	Gr.5/6	Gr.7/8	H.S.	PreK	PreK-8	PreK-12	Total	
Administration									
Superintendent							1.00	1.00	
Asst. Superintendent							1.00	1.00	
Dir. Business Services							1.00	1.00	
Dir. Special Education							1.00	1.00	
Dir. Of Human Resource							1.00	1.00	
Principals	4.00	1.00	1.00	1.00				7.00	
Asst. Principals	1.00	2.00	2.00	3.00				8.00	
Director of Technology							1.00	1.00	
Assistant Director Special Ed.							0.00	0.00	
Department Directors		0.60	0.60	3.80	1.00		2.80	8.80	
Athletic Director							1.00	1.00	
Subtotal	5.00	3.60	3.60	7.80	1.00	0.00	9.80	30.80	
Instructional: Classroom									
K-4 Classroom	91.50							91.50	
Academic Subjects (5-8)		34.00	32.00					66.00	
English/Language Arts				13.40				13.40	
Mathematics				13.80				13.80	
Science				13.40				13.40	
Social Studies				12.40				12.40	
Foreign Language		2.30	5.60	10.60				18.50	
ESL	4.00	1.00	1.00	1.20				7.20	
Subtotal	95.50	37.30	38.60	64.80	0.00	0.00	0.00	236.20	
Instructional: Specialist									
Fam & Con Science				3.00	0.80			3.80	
Technology Education			1.00	1.20				2.20	
Music	3.80	2.40	2.20	2.10				10.50	
Art	3.70	1.00	1.00	3.40				9.10	
Physical Education	4.00	2.00	2.00	6.00			0.60	14.60	
Instructional Technology / VHS	0.00	1.00	0.00	1.20				2.20	
Health Education	1.50	1.50	1.00	2.60				6.60	
Jobs for Bay State Graduates				0.00				0.00	
TV Studio				0.80				0.80	
Subtotal	13.00	7.90	7.20	20.30	0.80	0.00	0.60	49.80	
Instructional: Support									
Special Education	22.00	11.40	9.40	10.50	10.00		3.00	66.30	
Guidance			1.00	6.60				7.60	
Curriculum Coaches/Coord.	3.00	2.00	2.00					7.00	
Title I/Reading	1.00	1.00						2.00	
Media Specialists	1.00	0.50	0.50	1.00				3.00	
Adj. Coun/Sch. Psych.	5.60	3.00	2.00	2.00	0.60			13.20	
Speech/Language & OT							16.80	16.80	
Nurse	5.00	1.00	1.00	2.00	1.00			10.00	
Subtotal	37.60	18.90	15.90	22.10	11.60	0.00	19.80	125.90	
Classified Staff									
Tutors/Technology Support	10.90	0.80	2.60	2.00			7.00	23.30	
Instructional Aides	33.50			1.00	5.50			40.00	
SPED/ABA/COTA/Speech Aide	52.20	23.60	17.00	26.40	24.00		2.80	146.00	
Media Aides/Paraprofessionals	5.50	1.00	1.00	1.00				8.50	
Secretary	6.50	2.00	2.00	7.00	1.00		11.85	30.35	
Courier							1.00	1.00	
Subtotal	108.60	27.40	22.60	37.40	30.50	0.00	22.65	249.15	
Totals	259.70	95.10	87.90	152.40	43.90	0.00	52.85	691.85	

Shrewsbury Public Schools Staffing Projections FY 13 Budget March 14, 2012 School Committee Mtg.

Position	Elem.	Gr.5/6	Gr.7/8	H.S.	PreK	PreK-8	PreK-12	Total
Administration								
Superintendent							1.00	1.00
Asst. Superintendent							1.00	1.00
Dir. Business Services							1.00	1.00
Dir. Special Education							1.00	1.00
Dir. Of Human Resource							1.00	1.00
Principals	4.00	1.00	1.00	1.00				7.00
Asst. Principals	1.00	2.00	2.00	3.00				8.00
Director of Technology							1.00	1.00
Assistant Director Special Ed.							0.00	0.00
Department Directors		0.60	0.60	3.40	1.00		2.70	8.30
Athletic Director							1.00	1.00
Subtotal	5.00	3.60	3.60	7.40	1.00	0.00	9.70	30.30
Instructional: Classroom								
K-4 Classroom	93.00							93.00
Academic Subjects (5-8)		34.00	32.00					66.00
English/Language Arts				13.40				13.40
Mathematics				13.80				13.80
Science				13.60				13.60
Social Studies				12.40				12.40
Foreign Language		2.70	6.00	10.00				18.70
ESL	4.00	1.00	1.00	1.20				7.20
Subtotal	97.00	37.70	39.00	64.40	0.00	0.00	0.00	238.10
Instructional: Specialist								
Fam & Con Science				3.00	0.80			3.80
Technology Education			1.00	1.00				2.00
Music	3.70	2.40	2.30	2.20				10.60
Art	3.70	1.00	1.00	3.40				9.10
Physical Education	4.00	2.00	2.00	4.00			0.40	12.40
Instructional Technology / VHS	0.00	1.00	0.00	1.20				2.20
Health Education	1.70	1.50	1.00	2.60				6.80
Jobs for Bay State Graduates				0.00				0.00
TV Studio				0.80				0.80
Subtotal	13.10	7.90	7.30	18.20	0.80	0.00	0.40	47.70
Instructional: Support								
Special Education	22.00	11.40	9.40	10.70	9.80		3.00	66.30
Guidance			1.00	7.00				8.00
Curriculum Coaches/Coord.	3.00	2.00	2.00					7.00
Title I/Reading	1.00	1.00						2.00
Media Specialists	1.00	0.50	0.50	1.00				3.00
Adj. Coun/Sch. Psych.	5.60	3.00	2.00	2.00	0.60			13.20
Speech/Language & OT							16.20	16.20
Nurse	5.00	1.00	1.00	2.00	1.00			10.00
Subtotal	37.60	18.90	15.90	22.70	11.40	0.00	19.20	125.70
Classified Staff								
Tutors/Technology Support	10.90	0.80	2.60	2.00			7.00	23.30
Instructional Aides	27.10			1.00	4.50			32.60
SPED/ABA/COTA/Speech Aide	66.20	22.60	17.00	24.30	20.50		2.70	153.30
Media Aides/Paraprofessionals	5.50	1.00	1.00	1.00				8.50
Secretary	6.50	2.00	2.00	7.00	1.00		11.85	30.35
Courier							1.00	1.00
Subtotal	116.20	26.40	22.60	35.30	26.00	0.00	22.55	249.05
Totals	268.90	94.50	88.40	148.00	39.20	0.00	51.85	690.85

Shrewsbury Public Schools		Staffing Levels Oct. 1, 2011; presented to SC on October 26, 2011							
Position	◆	Elem.◆	Gr.5/◆	Gr.7/◆	H.S.◆	PreK◆	PreK-8◆	PreK-12◆	Total◆
Administration									
Superintendent								1.00	1.00
Asst. Superintendent								1.00	1.00
Dir. Business Services								1.00	1.00
Dir. Special Education								1.00	1.00
Dir. Of Human Resource								1.00	1.00
Principals		5.00	1.00	1.00	1.00				8.00
Asst. Principals		1.00	2.00	2.00	3.00				8.00
Director of Technology								1.00	1.00
Assistant Director Special Ed.								0.00	0.00
Department Directors			0.60	0.60	3.40	1.00		3.50	9.10
Athletic Director								1.00	1.00
Subtotal		6.00	3.60	3.60	7.40	1.00	0.00	10.50	32.10
Instructional: Classroom									
K-4 Classroom		96.00							96.00
Academic Subjects (5-8)			36.00	36.00					72.00
English/Language Arts					14.40				14.40
Mathematics					14.80				14.80
Science					14.20				14.20
Social Studies					13.40				13.40
Foreign Language			2.70	5.60	10.80				19.10
ESL		4.00	1.00	1.00	1.20				7.20
Subtotal		100.00	39.70	42.60	68.80	0.00	0.00	0.00	251.10
Instructional: Specialist									
Fam & Con Science					3.00	0.80			3.80
Technology Education				1.00	1.00				2.00
Music		3.70	2.40	2.30	2.20				10.60
Art		3.70	1.00	1.00	4.40				10.10
Physical Education		4.00	2.00	2.00	4.00		0.40		12.40
Instructional Technology / VHS		0.00	2.00	0.00	1.20				3.20
Health Education		1.70	1.50	1.00	2.60				6.80
Jobs for Bay State Graduates					0.00				0.00
TV Studio					0.80				0.80
Subtotal		13.10	8.90	7.30	19.20	0.80	0.00	0.40	49.70
Instructional: Support									
Special Education		22.00	11.40	10.40	10.70	9.30		3.00	66.80
Guidance				1.00	7.00				8.00
Curriculum Coaches/Coord.		3.00	2.50	2.50					8.00
Title I/Reading		1.00	1.00						2.00
Media Specialists		1.00	0.50	0.50	1.00				3.00
Adj. Coun/Sch. Psych.		5.60	3.00	2.00	2.00	0.60			13.20
Speech/Language & OT								16.20	16.20
Nurse		5.00	1.00	1.00	2.00	1.00			10.00
Subtotal		37.60	19.40	17.40	22.70	10.90	0.00	19.20	127.20
Classified Staff									
Tutors/Technology Support		10.90	0.80	2.60	2.00			7.00	23.30
Instructional Aides		31.10			1.00	6.00			38.10
SPED/ABA/COTA/Speech Aide		66.20	24.60	19.00	26.80	20.50		2.70	159.80
Media Aides/Paraprofessionals		5.50	1.00	1.00	1.00				8.50
Secretary		6.50	2.00	2.00	7.00	1.00		11.85	30.35
Courier								1.00	1.00
Subtotal		120.20	28.40	24.60	37.80	27.50	0.00	22.55	261.05
Totals		276.90	100.00	95.50	155.90	40.20	0.00	52.65	721.15



**SHREWSBURY PUBLIC SCHOOLS
SCHOOL COMMITTEE**

ITEM NO: V. Curriculum

MEETING DATE: 10/23/13

SPECIFIC STATEMENT OR QUESTION:

BACKGROUND INFORMATION:

ACTION RECOMMENDED:

STAFF AVAILABLE FOR PRESENTATION:



SHREWSBURY PUBLIC SCHOOLS
SCHOOL COMMITTEE

ITEM NO: VI. Policy

MEETING DATE: 10/23/13

A. Bullying Prevention and Intervention Update: Second Reading

SPECIFIC STATEMENT OR QUESTION:

Will the School Committee hear a second reading and vote to approve an updated policy on Bullying Prevention and Intervention and the mandated Bullying Prevention and Intervention Plan?

BACKGROUND INFORMATION:

1. The Massachusetts Legislature recently passed an amendment to the anti-bullying law that requires school district anti-bullying policies and plans to specifically indicate that they apply to staff members as well.
2. At the October 9, 2013, Dr. Sawyer presented updated documents that reflect the new requirements.
3. The proposed language has not changed since October 9; please refer to the October 9 packet for the documents.

ACTION RECOMMENDED:

That the School Committee hear a second reading and vote to approve an updated policy on Bullying Prevention and Intervention and the mandated Bullying Prevention and Intervention Plan.

STAFF AVAILABLE FOR PRESENTATION:

Dr. Joseph M. Sawyer, Superintendent of Schools



**SHREWSBURY PUBLIC SCHOOLS
SCHOOL COMMITTEE**

ITEM NO: VII. Budget

MEETING DATE: 10/23/13

SPECIFIC STATEMENT OR QUESTION:

BACKGROUND INFORMATION:

ACTION RECOMMENDED:

STAFF AVAILABLE FOR PRESENTATION:



**SHREWSBURY PUBLIC SCHOOLS
SCHOOL COMMITTEE**

ITEM NO: VIII. Old Business

MEETING DATE: 10/23/13

SPECIFIC STATEMENT OR QUESTION:

BACKGROUND INFORMATION:

ACTION RECOMMENDED:

STAFF AVAILABLE FOR PRESENTATION:



**SHREWSBURY PUBLIC SCHOOLS
SCHOOL COMMITTEE**

ITEM NO: IX. New Business

MEETING DATE: 10/23/13

A. Proposed Dedication of Parker Road Preschool Playground

SPECIFIC STATEMENT OR QUESTION:

Will the School Committee vote to dedicate the renovated Parker Road Preschool Playground in honor of Andrew "Drew" Stevens?

BACKGROUND INFORMATION:

1. The enclosed memo from Ms. Robinson requests that the renovated playground be named "Drew's Dream Playground" in honor of Drew Stevens, a Parker Road student who passed away in 2012.
2. The "Drew's Dream" Committee has raised funds for the playground renovation.

ACTION RECOMMENDED:

That the School Committee vote to dedicate the renovated Parker Road Preschool Playground by naming it "Drew's Dream Playground" in honor of Andrew "Drew" Stevens.

STAFF AVAILABLE FOR PRESENTATION:

Dr. Joseph M. Sawyer, Superintendent of Schools



SHREWSBURY PUBLIC SCHOOLS

Parker Road Preschool
15 Parker Road, Shrewsbury, MA 01545

Lisa Robinson, Director
P: 508.841.8646 F: 508.841.8787
lrobinson@shrewsbury.k12.ma.us

October 15, 2013

Dear School Committee,

We are writing to request your permission to dedicate our recently renovated playground at 15 Parker Road in honor of Andrew "Drew" Stevens, a Parker Road Preschool student who passed away in April 2012. In order to honor Drew's memory, the Drew's Dream Committee was formed in order to raise money to install improved playground equipment, including a structure that would represent Drew's love of fire trucks. The playground will be ready in the very near future. A sign would include the following:

Drew's Dream Playground
in honor of Andrew "Drew" Stevens
a Parker Road friend

The Drew's Dream Committee wishes to thank our very generous
community partners:
Drew's Family and Friends
Home Depot of Shrewsbury
Kimball Sand Company
Worcester Tree & Stump

We appreciate your consideration of our request.

Sincerely,

Lisa Robinson



SHREWSBURY PUBLIC SCHOOLS
SCHOOL COMMITTEE

ITEM NO: X. **Approval of Minutes**

MEETING DATE: **10/23/13**

SPECIFIC STATEMENT OR QUESTION:

BACKGROUND INFORMATION:

ACTION RECOMMENDED:

STAFF AVAILABLE FOR PRESENTATION:



SHREWSBURY PUBLIC SCHOOLS
SCHOOL COMMITTEE

ITEM NO: XI. **Executive Session**

MEETING DATE: 10/23/13

SPECIFIC STATEMENT OR QUESTION:

Will the School Committee enter into executive session for the purpose of discussing negotiations where discussion in open session may have a detrimental effect on the bargaining position of the public body?

BACKGROUND INFORMATION:

That the School Committee discuss the information presented and take such action as it deems to be in best interests of Shrewsbury Public Schools.

ACTION RECOMMENDED:

That the School Committee enter into executive session.

STAFF AVAILABLE FOR PRESENTATION:

Ms. Barbara A. Malone, Director of Human Resources
Dr. Joseph Sawyer, Superintendent of Schools



**SHREWSBURY PUBLIC SCHOOLS
SCHOOL COMMITTEE**

ITEM NO: **XII. Information Enclosures**
ITEM NO: **XIII. Adjournment**

MEETING DATE: **10/23/13**

SPECIFIC STATEMENT OR QUESTION:

BACKGROUND INFORMATION:

ACTION RECOMMENDED:

STAFF AVAILABLE FOR PRESENTATION:

)